

RICH COUNTY

SECTIONS
13,14,23,24

T. 14 N.R. 7 E., S.L.B. & M.

43-SEC-000-PARCEL

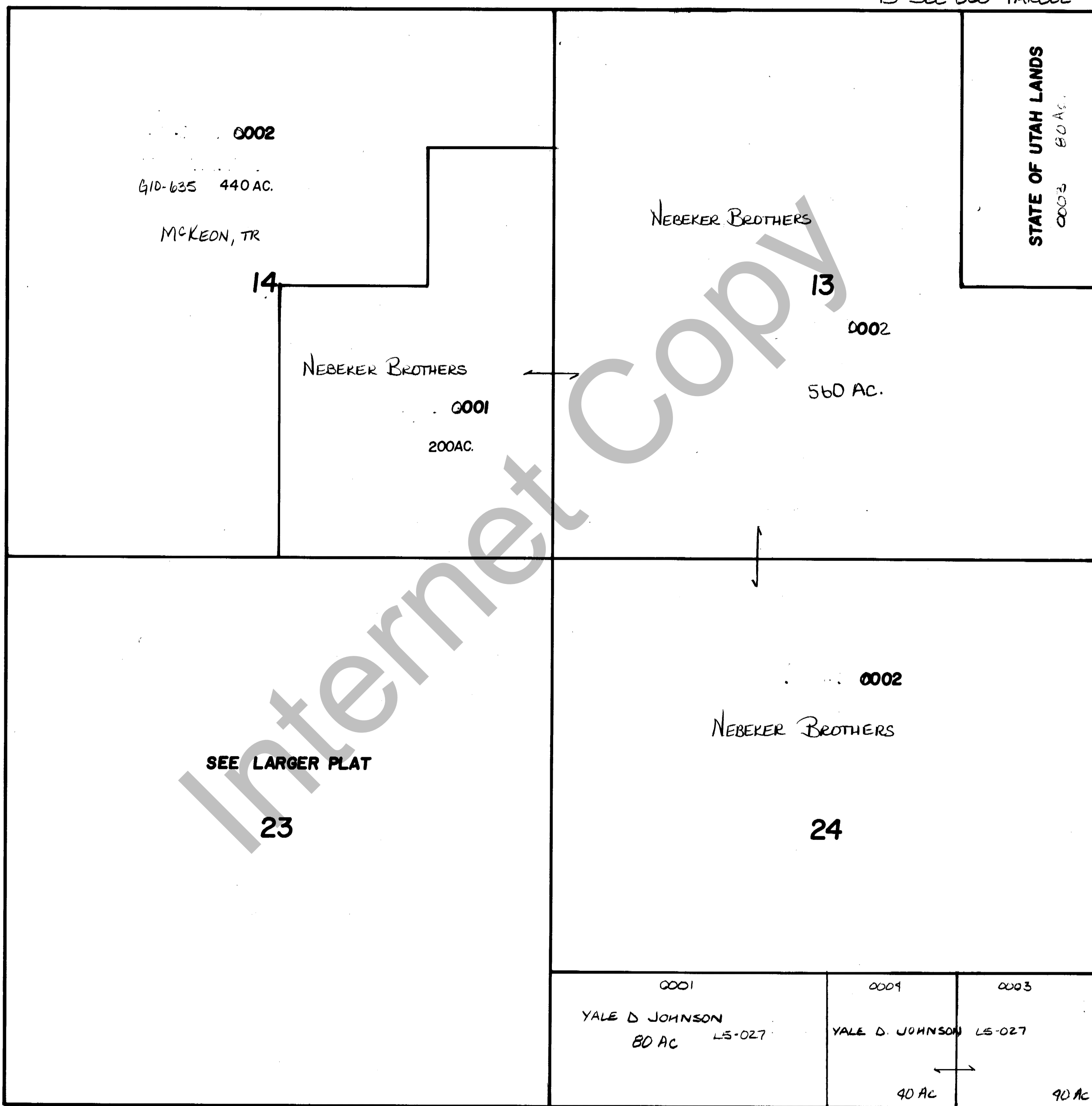

SEE LARGER PLAT

REVISIONS		

THIS PLAT IS MADE SOLELY FOR THE PURPOSE OF ASSISTING IN LOCATING THE LAND, AND THE RECORDER ASSUMES NO LIABILITY FOR VARIATIONS, IF ANY, WITH AN ACTUAL SURVEY.

1413
Section 24 T. 14 N. R. 7 E.
drawn by MVH date 11-80

book page
scale 1"=800'