

RICH COUNTY  
 SECTION 12 , T.14 N.R 7 E,S.LB&M

SERIAL NO = 43-12-000 PARCEL

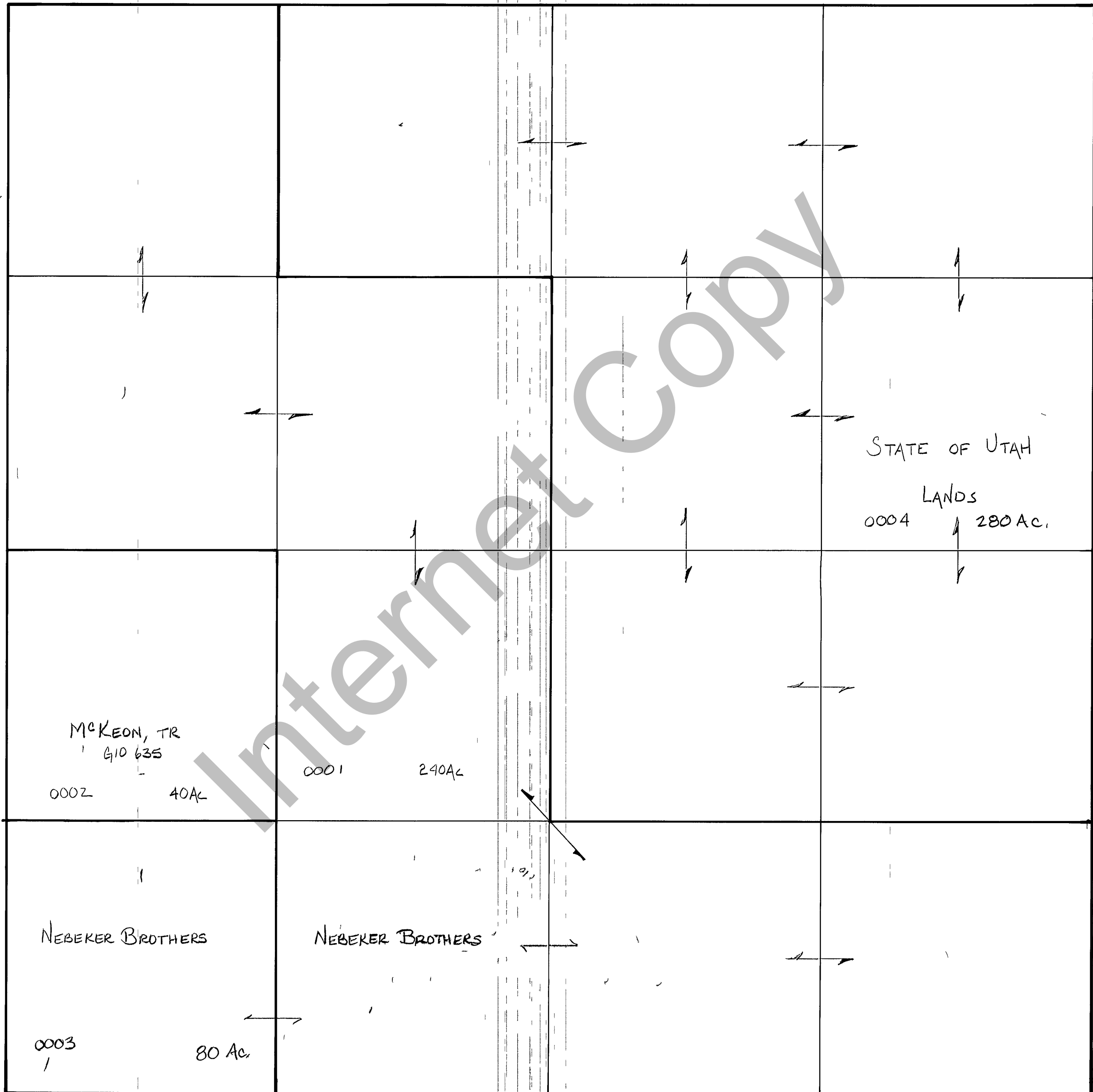

REVISIONS		

THIS PLAT IS MADE SOLELY FOR THE PURPOSE OF ASSISTING IN LOCATING THE LAND AND THE RECORDER ASSUMES NO LIABILITY FOR VARIATIONS, IF ANY WITH AN ACTUAL SURVEY

Section 12 T 14 N. R 7 E.

book page

drawn by DW date 2-80

scale 1" = 400'