

RICH COUNTY  
 SECTION 32 T. 13 N. R. 7 E., S.L.B. & M.

38-32-000-PARCEL

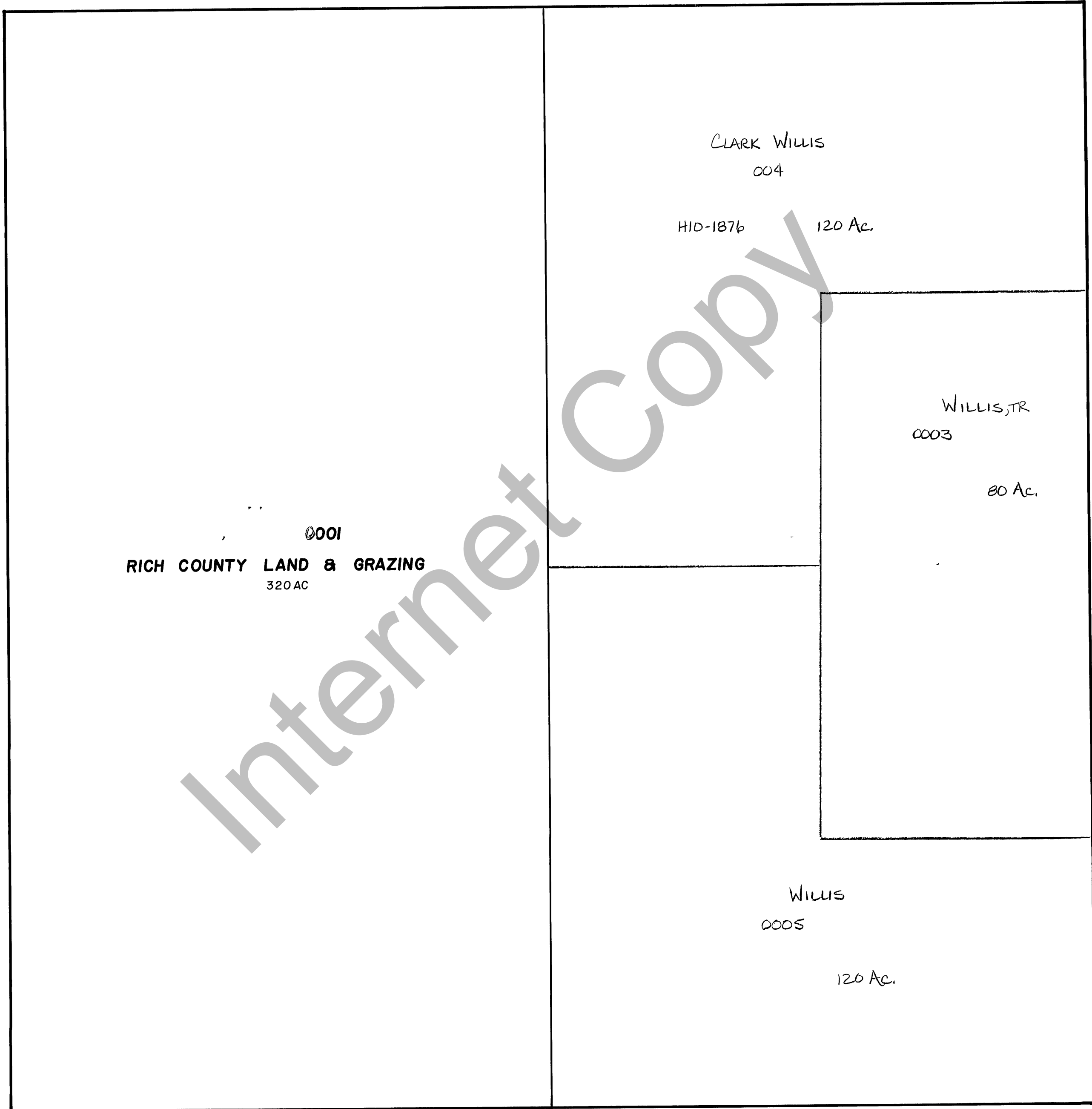

0001  
 RICH COUNTY LAND & GRAZING  
 320 AC

CLARK WILLIS  
 004

H10-1876 120 Ac.

WILLIS, TR  
 0003  
 80 Ac.

WILLIS  
 0005  
 120 Ac.

REVISIONS		

THIS PLAT IS MADE SOLELY FOR THE PURPOSE OF ASSESSING IN LOCATING THE LAND, AND THE RECORDER ASSUMES NO LIABILITY FOR VARIATIONS, OF ANY, WITH AN ACTUAL SURVEY.

Section 32 T 13 N R 7 E  
 drawn by MVH date 11-80

book \_\_\_\_\_ page \_\_\_\_\_  
 scale 1"=400'