

RICH COUNTY
SECTION 25, T. 13 N. R. 7 E., S.L.B. & M.

SERIAL NO. = 38-25-000-PARCEL

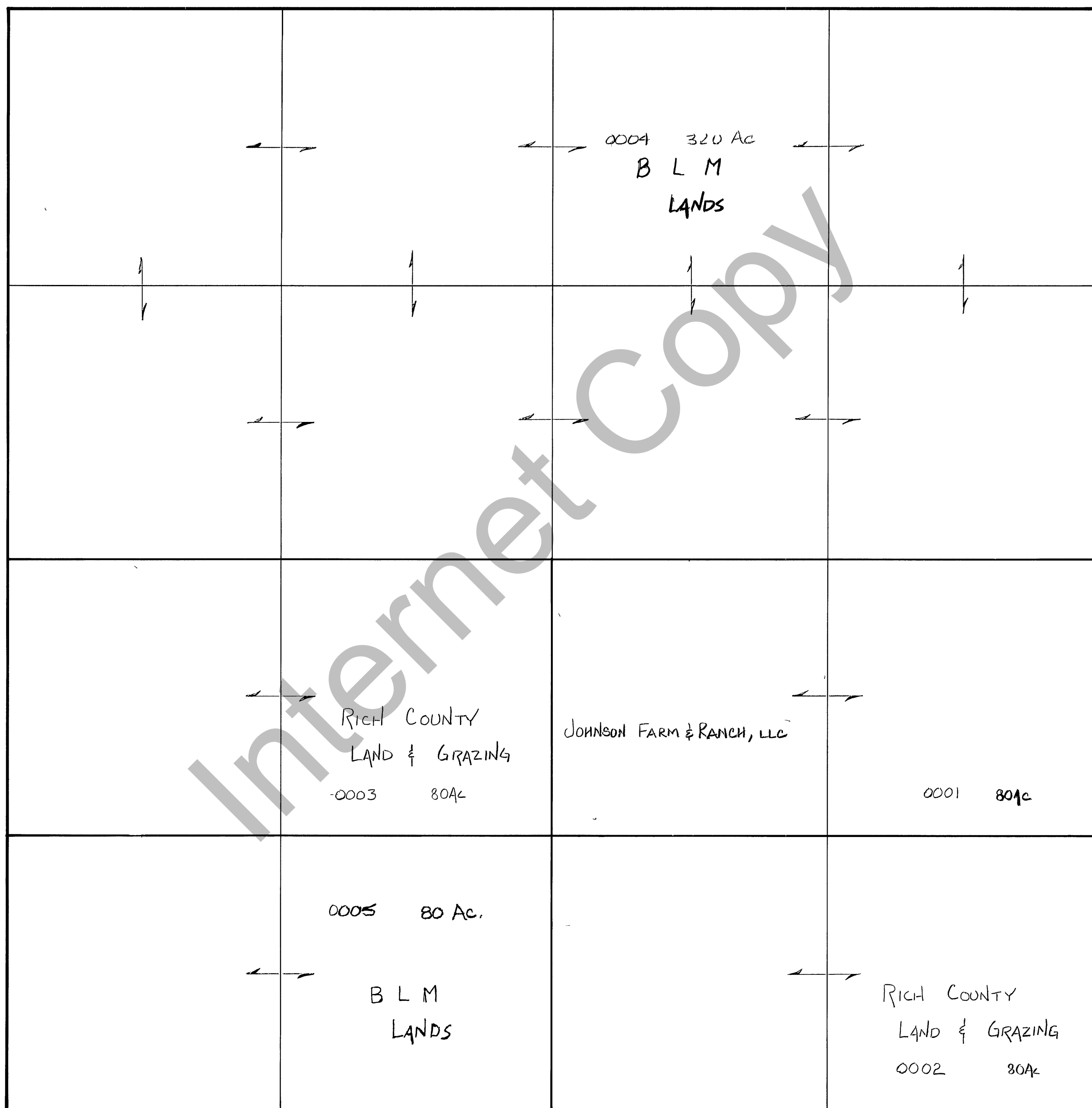

Internet Copy

REVISIONS	

THIS PLAT IS MADE SOLELY FOR THE PURPOSE OF ASSISTING IN LOCATING THE LAND, AND THE RECORDER ASSUMES NO LIABILITY FOR VARIATIONS, IF ANY, WITH AN ACTUAL SURVEY

Section 25 T 13 N. R 7 E

book page

drawn by DW date 12-79

scale 1" = 400'