

RICH COUNTY  
 SECTION 11 T. 12 N. R. 7 E., S.L.B. & M.

33-11-000-PARCEL

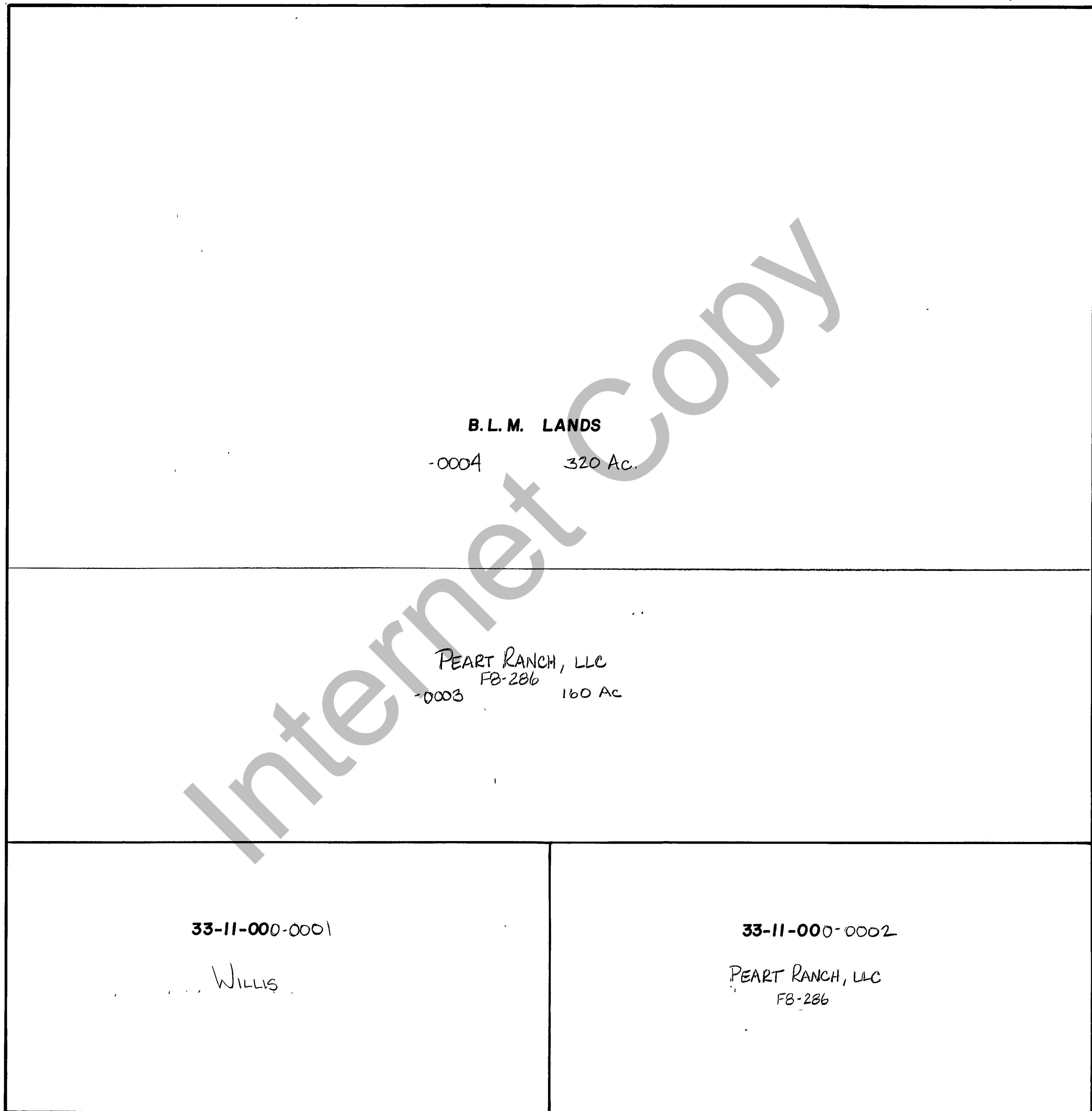

REVISIONS		

THIS PLAT IS MADE SOLELY FOR THE PURPOSE OF ASSISTING IN LOCATING THE LAND, AND THE RECORDER ASSUMES NO LIABILITY FOR VARIATIONS, IF ANY, WITH AN ACTUAL SURVEY.

Section 11 T. 12N R. 7E  
 drawn by MVH date 11-80

book \_\_\_\_\_ page \_\_\_\_\_  
 scale 1"=400'