

LAKE RESIDENCES AT BEAR LAKE PHASE 8B

LEGEND

-  UNIT BOUNDARY
-  COMMON AREAS AND FACILITIES* / WITHDRAWABLE LAND
-  LIMITED COMMON AREAS AND FACILITIES / WITHDRAWABLE LAND
-  CONVERTIBLE SPACE / WITHDRAWABLE LAND
-  PRIVATE SPACE / WITHDRAWABLE LAND

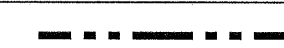
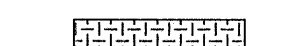
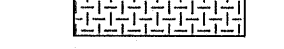
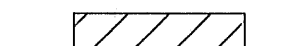
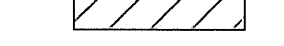
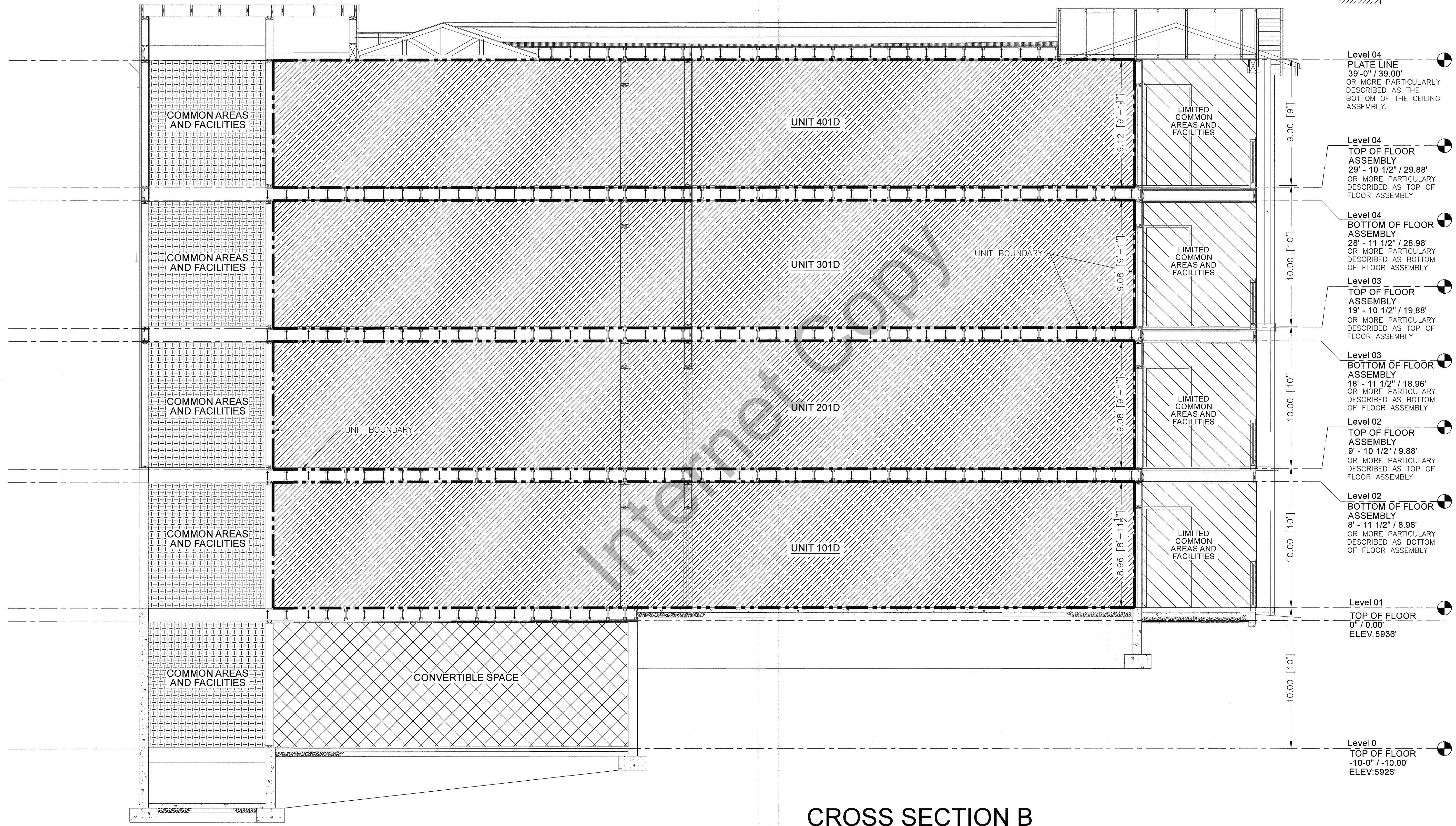

CROSS SECTION B

SCALE 1"=5'

PROJECT
C19-027

SHEET
4 OF 7

ISSUE DATE
12/08/2021

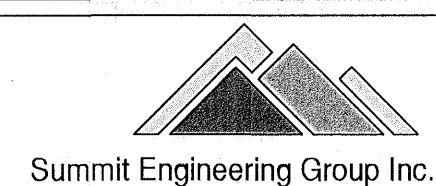

Structural • Civil • Surveying
55 WEST CENTER • P.O. BOX 176
HEBER CITY, UTAH 84032
P: 435-654-9228 • F: 435-654-9231

COPYRIGHT © 2021
SUMMIT ENGINEERING GROUP, INC.
DRAWING ALTERATION
IT IS A VIOLATION OF LAW FOR ANY PERSON, UNLESS ACTING UNDER THE DIRECTION OF THE PROFESSIONAL LAND SURVEYOR TO ALTER ANY ITEM ON THIS DOCUMENT IN ANY WAY. ANY LICENSEE WHO ALTERS THIS DOCUMENT IS REQUIRED BY LAW TO SIGN AND DATE THE NOTATION "ALTERED BY" FOLLOWED BY THEIR SIGNATURE AND SPECIFIC DESCRIPTION OF THE ALTERATIONS.

LAKE RESIDENCES AT BEAR LAKE PHASE 8B

LOCATED IN THE NORTHWEST ¼ OF SECTION 21, TOWNSHIP 14 NORTH, RANGE 5 EAST, SLB&M,
GARDEN CITY, RICH COUNTY, UTAH