

LAKE RESIDENCES AT BEAR LAKE PHASE 8B

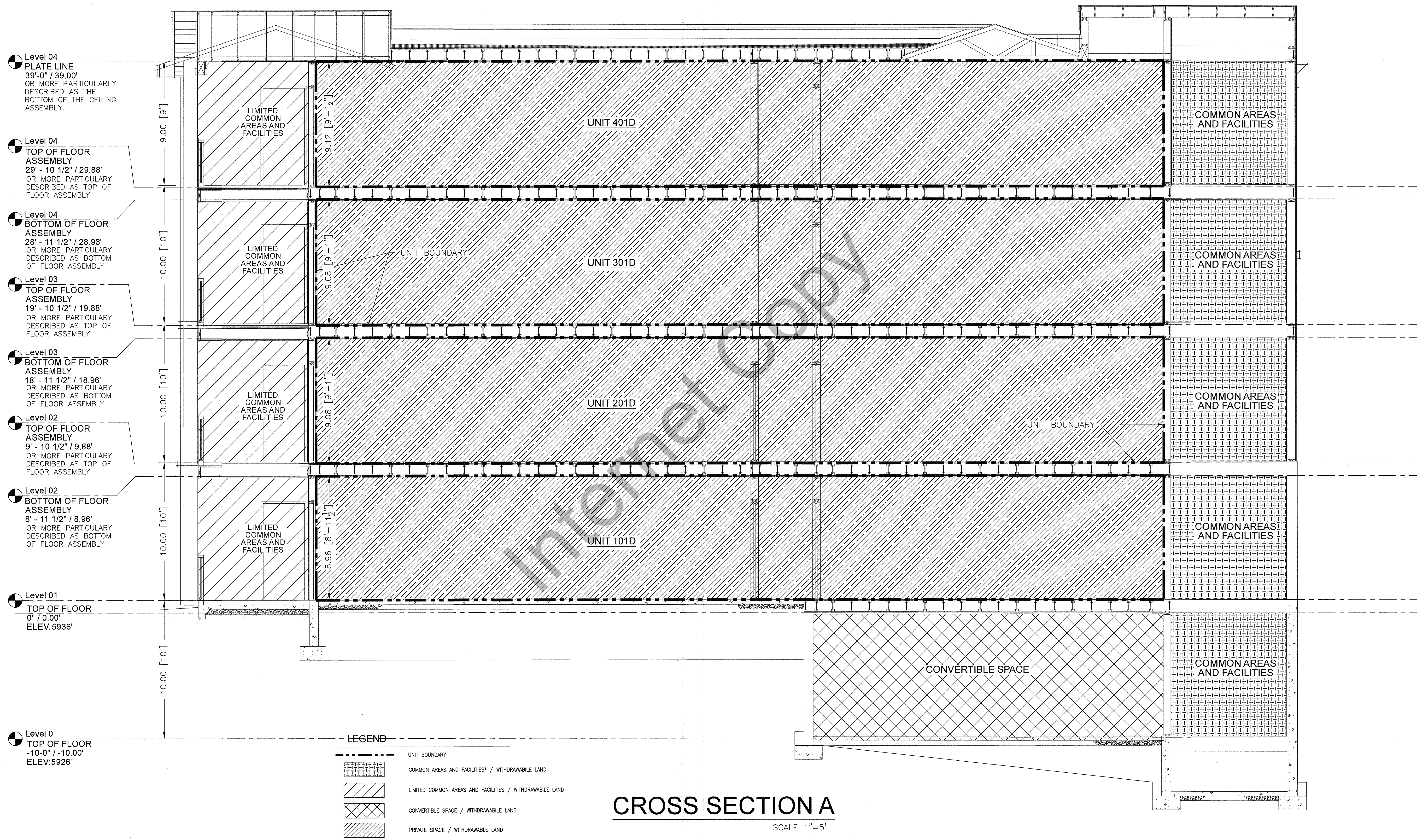

PROJECT
C19-027
SHEET
3 OF 7
ISSUE DATE
12/08/2021

Summit Engineering Group Inc.
Structural • Civil • Surveying
55 WEST CENTER • P.O. BOX 176
HEBER CITY, UTAH 84033
P: 435-654-9228 • F: 435-654-9231

COPYRIGHT © 2021
SUMMIT ENGINEERING GROUP, INC.
DRAWING ALTERATION
IT IS A VIOLATION OF LAW FOR ANY
PERSON, UNLESS ACTING UNDER THE
DIRECTION OF THE PROFESSIONAL LAND
SURVEYOR TO ALTER ANY ITEM ON THIS
DRAWING. ANY ALTERATION TO THIS
DRAWING TO BE MADE MUST BE IN
ACCORDANCE WITH THE UTAH
NOTATION "ALTERED BY" FOLLOWED BY
THEIR SIGNATURE AND SPECIFIC DESCRIPTION
OF THE ALTERATIONS.

LAKE RESIDENCES AT BEAR LAKE PHASE 8B

LOCATED IN THE NORTHWEST 1/4 OF SECTION 21, TOWNSHIP 14 NORTH, RANGE 5 EAST, SLB&M,
GARDEN CITY, RICH COUNTY, UTAH