



# LAKE RESIDENCES AT BEAR LAKE PHASE 7B

## LEGEND

-  UNIT BOUNDARY
-  COMMON AREAS AND FACILITIES\* / WITHDRAWABLE LAND
-  LIMITED COMMON AREAS AND FACILITIES / WITHDRAWABLE LAND
-  PRIVATE SPACE / WITHDRAWABLE LAND

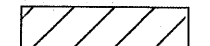
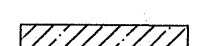
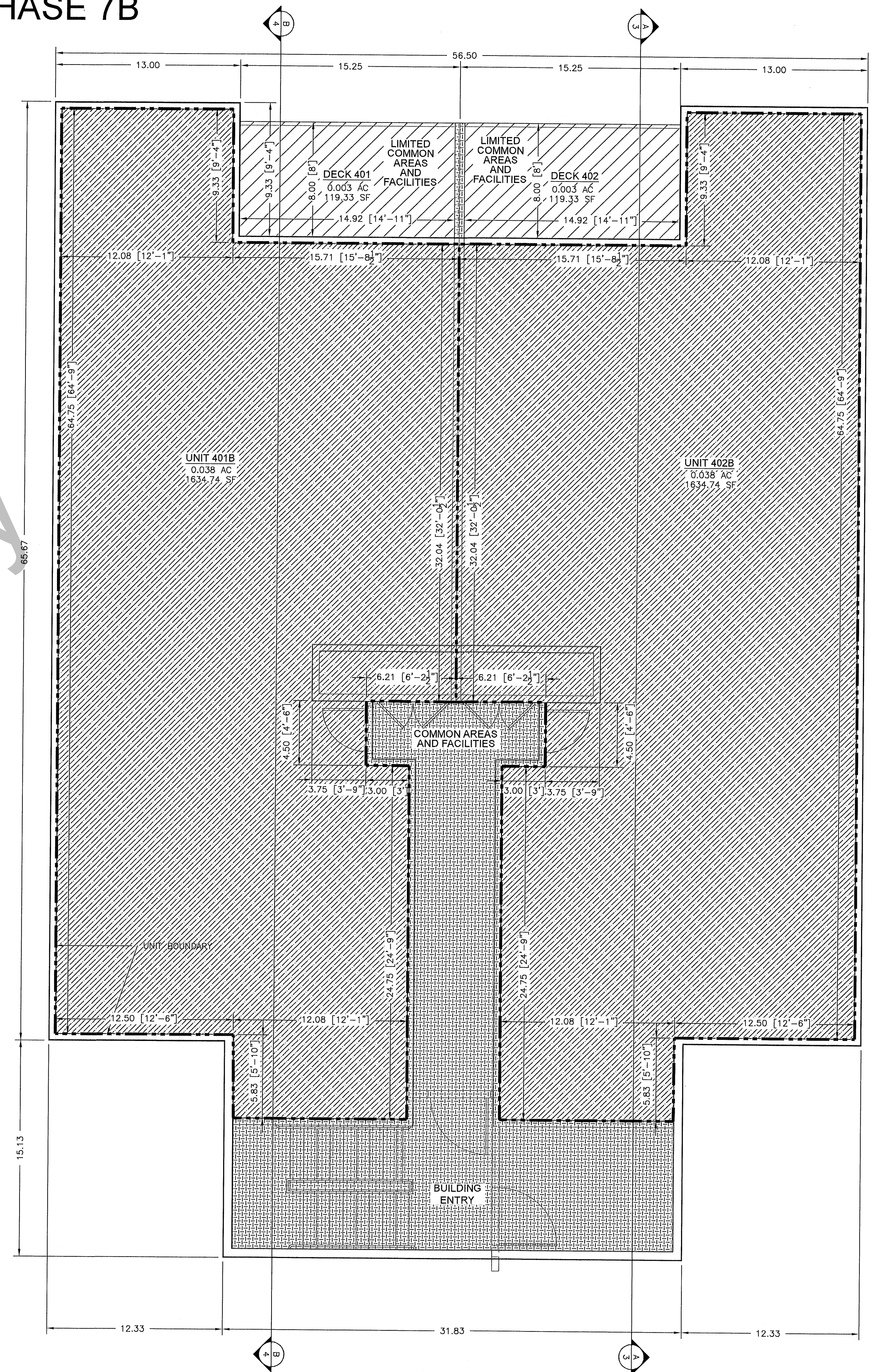

**FORTH FLOOR**  
SCALE 1"=5'

PROJECT  
C19-027

SHEET  
7 OF 7

ISSUE DATE  
02/14/2022

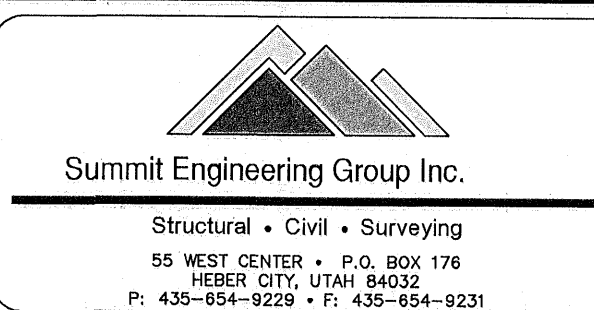

COPYRIGHT © 2022  
SUMMIT ENGINEERING GROUP, INC.  
DRAWING ALTERATION  
IT IS A VIOLATION OF LAW FOR ANY  
PERSON, UNLESS ACTING UNDER THE  
DIRECTION OF THE PROFESSIONAL LAND  
SURVEYOR TO ALTER ANY ITEM ON THIS  
DOCUMENT IN ANY WAY. ANY LICENSEE WHO  
ALTERS THIS DOCUMENT IS REQUIRED BY  
LAW TO AFFIX THEIR SEAL AND THE  
ACTION TAKEN BEING FOLLOWED BY  
THEIR SIGNATURE AND SPECIFIC DESCRIPTION  
OF THE ALTERATION.

# LAKE RESIDENCES AT BEAR LAKE PHASE 7B

LOCATED IN THE NORTHWEST ¼ OF SECTION 21, TOWNSHIP 14 NORTH, RANGE 5 EAST, SLB&M,  
GARDEN CITY, RICH COUNTY, UTAH