





LAKE RESIDENCES AT BEAR LAKE PHASE 7B

LEGEND

-  UNIT BOUNDARY
-  COMMON AREAS AND FACILITIES* / WITHDRAWABLE LAND
-  LIMITED COMMON AREAS AND FACILITIES / WITHDRAWABLE LAND
-  CONVERTIBLE SPACE / WITHDRAWABLE LAND
-  PRIVATE SPACE / WITHDRAWABLE LAND

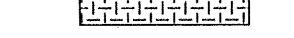

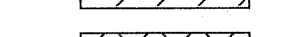
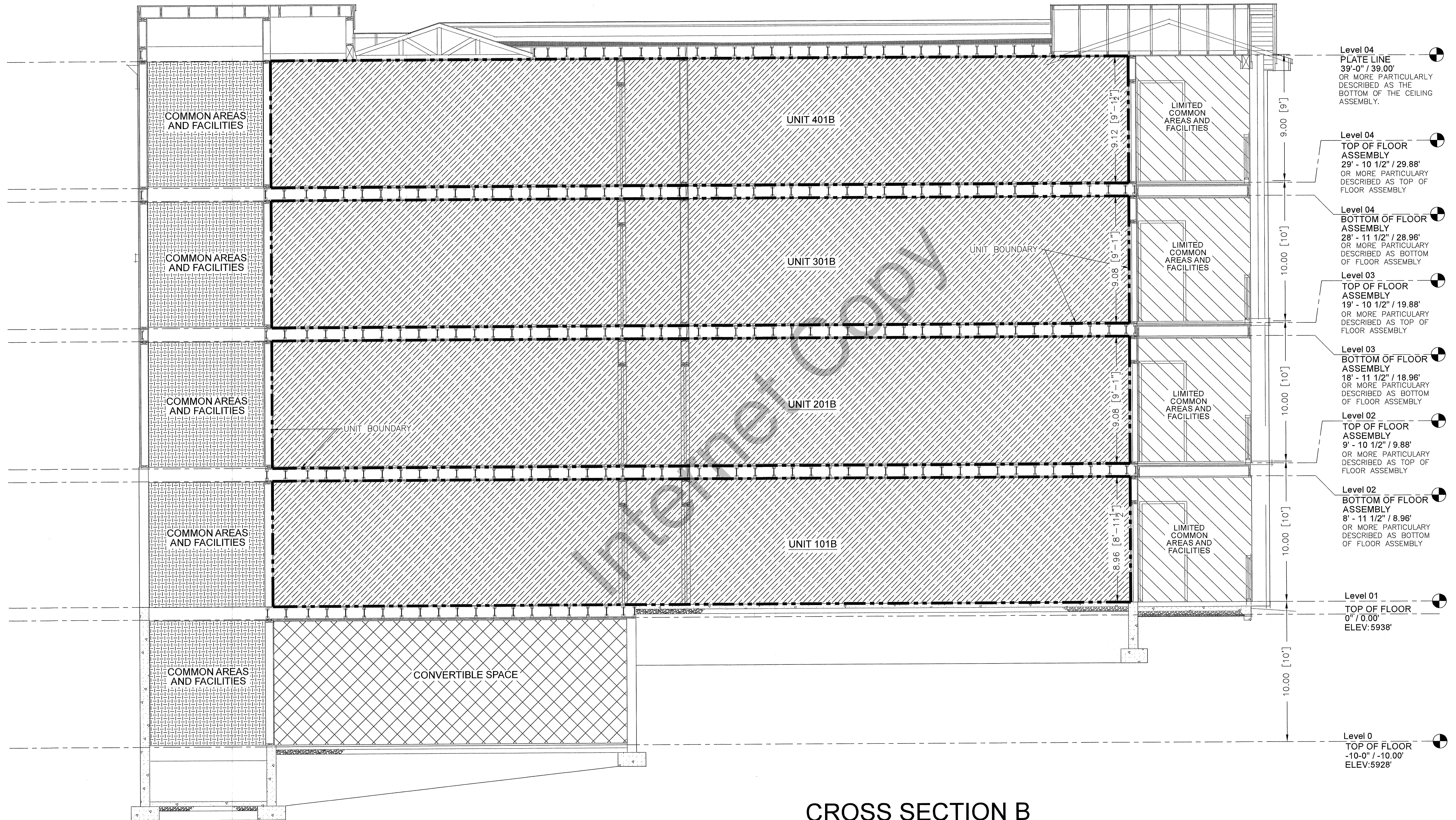
CROSS SECTION B

SCALE 1"=5'

LAKE RESIDENCES AT BEAR LAKE PHASE 7B

LOCATED IN THE NORTHWEST 1/4 OF SECTION 21, TOWNSHIP 14 NORTH, RANGE 5 EAST, SLB&M, GARDEN CITY, RICH COUNTY, UTAH

PROJECT
C19-027
SHEET
4 OF 7
ISSUE DATE
02/14/2022

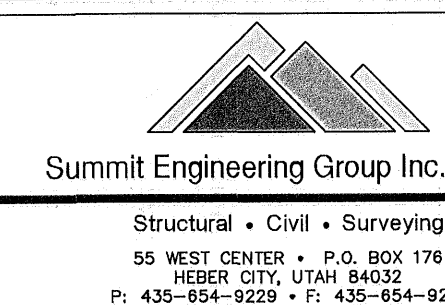

COPYRIGHT © 2022
SUMMIT ENGINEERING GROUP, INC.
DRAWING ALTERATION
IT IS A VIOLATION OF LAW FOR ANY PERSON, UNLESS ACTING UNDER THE DIRECTION OF THE PROFESSIONAL LAND SURVEYOR TO ALTER ANY ITEM ON THIS DOCUMENT IN ANY MANNER UNLESS AND UNLESS THIS DOCUMENT IS FOLLOWED BY THE SIGNATURE AND SPECIFIC DESCRIPTION OF THE ALTERATIONS.