

# LAKE RESIDENCES AT BEAR LAKE PHASE 7B

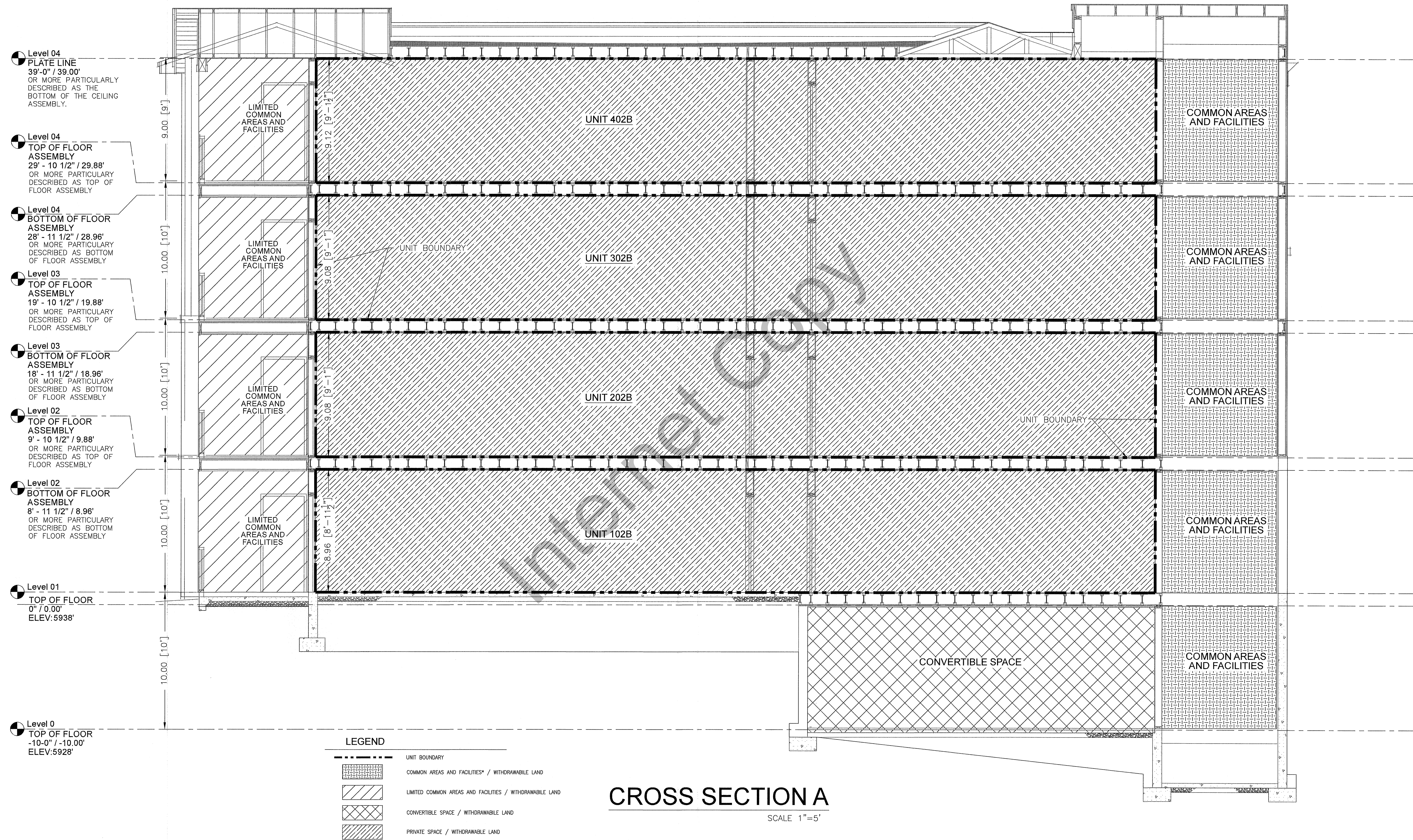

PROJECT  
C19-027  
SHEET  
3 OF 7  
ISSUE DATE  
02/14/2022

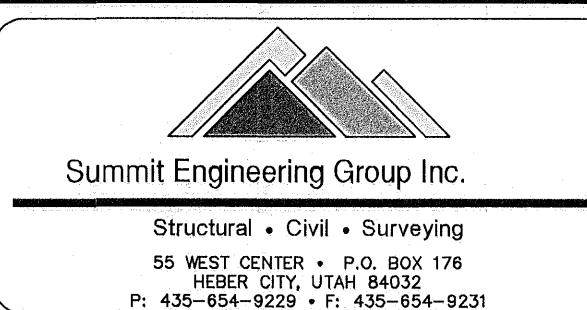

COPYRIGHT © 2022  
SUMMIT ENGINEERING GROUP, INC.  
DRAWING ALTERATION  
IT IS A VIOLATION OF LAW FOR ANY  
PERSON, UNLESS ACTING UNDER THE  
DIRECTION OF THE PROFESSIONAL ENGINEER  
SURVEYOR TO ALTER ANY ITEM ON THIS  
DRAWING IN ANY MANNER. ANY PERSON WHO  
ALTERS THIS DOCUMENT IS REQUIRED BY  
LAW TO AFFIX THEIR SEAL AND THE  
NOTATION "ALTERED BY" FOLLOWED BY  
THEIR SIGNATURE AND SPECIFIC DESCRIPTION  
OF THE ALTERATIONS.

## LAKE RESIDENCES AT BEAR LAKE PHASE 7B

LOCATED IN THE NORTHWEST 1/4 OF SECTION 21, TOWNSHIP 14 NORTH, RANGE 5 EAST, SLB&M,  
GARDEN CITY, RICH COUNTY, UTAH