

# LAKE RESIDENCES AT BEAR LAKE PHASE 7A

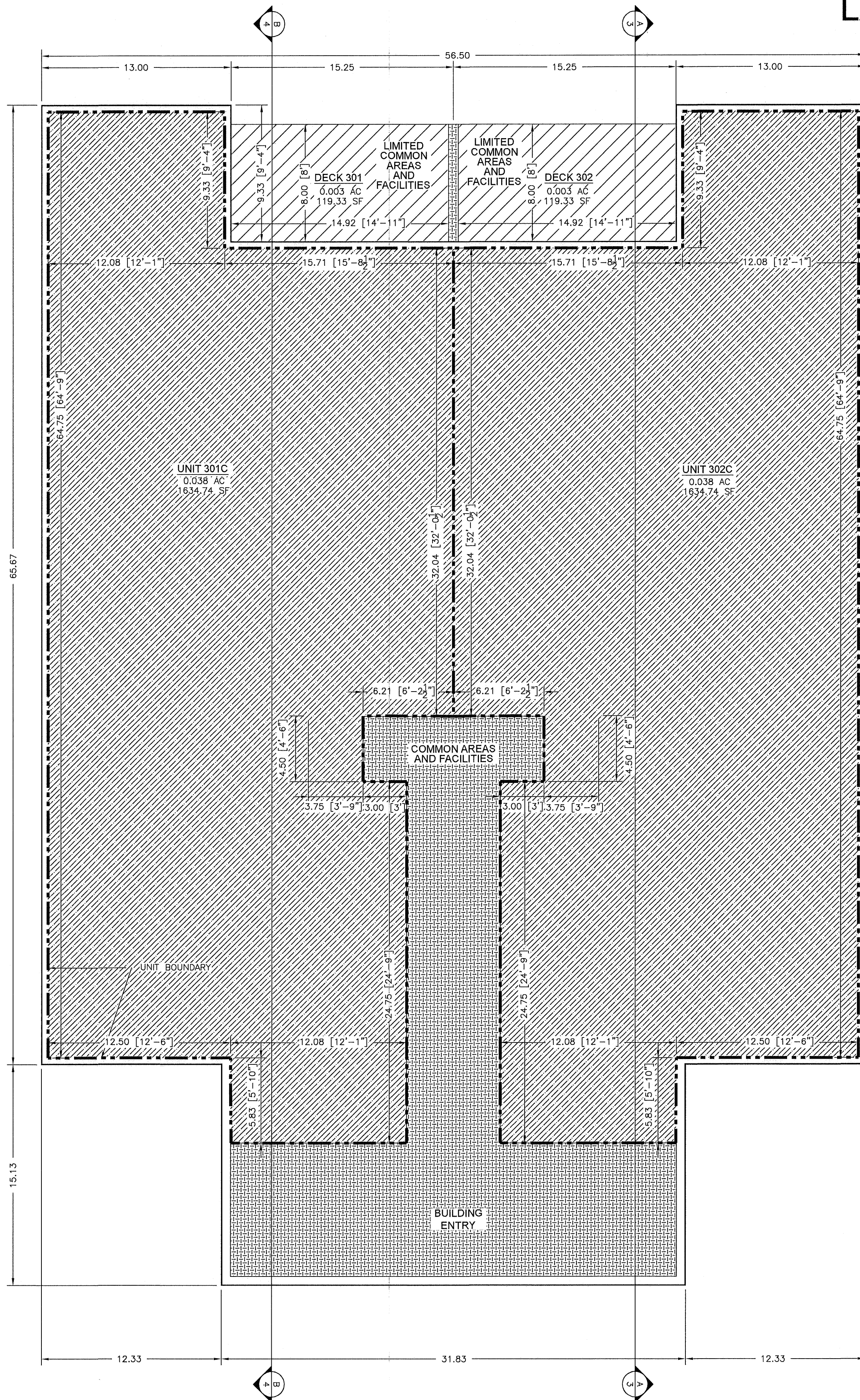

**THIRD FLOOR**  
SCALE 1"=5'

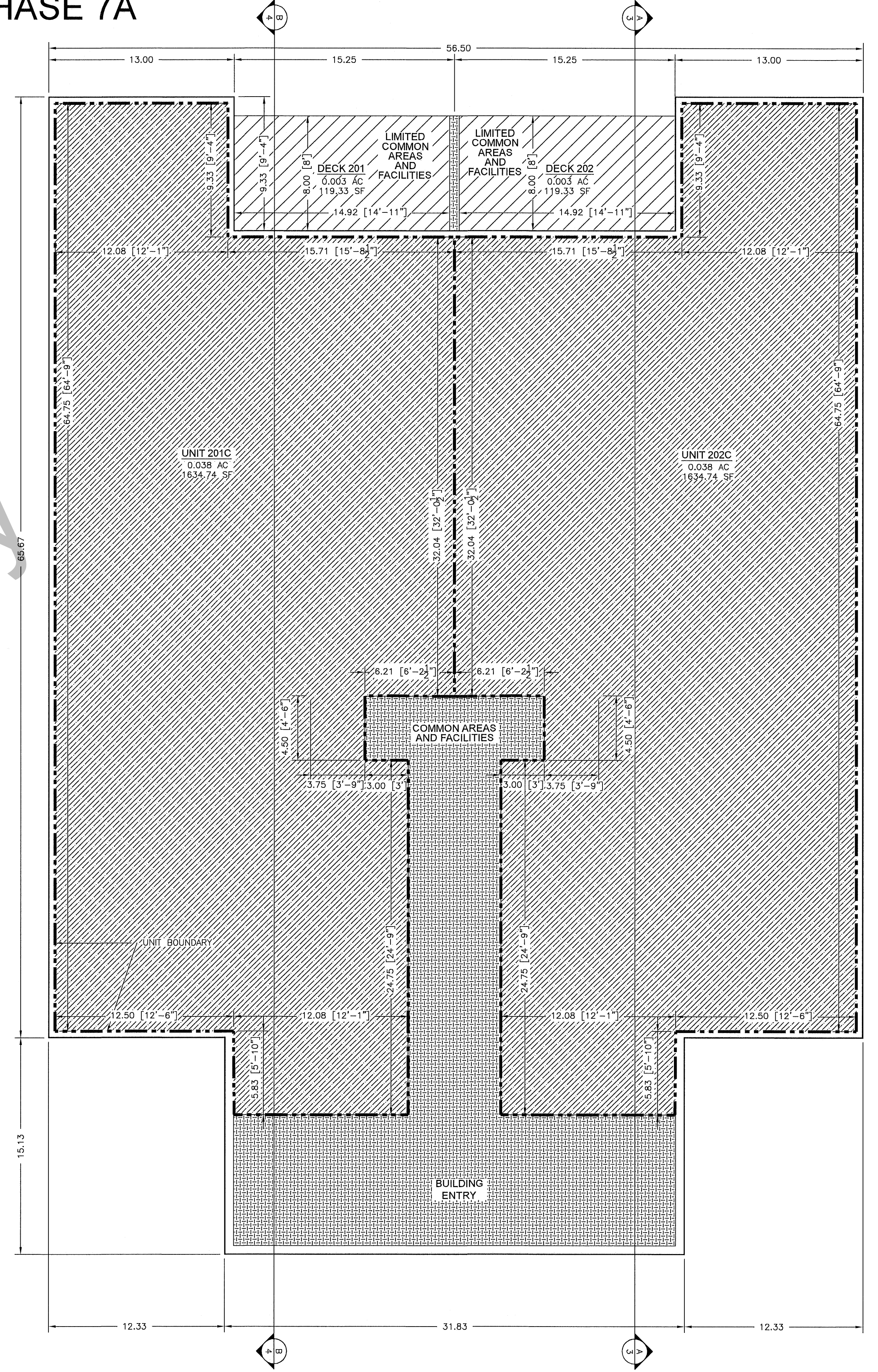

**SECOND FLOOR**  
SCALE 1"=5'

# LAKE RESIDENCES AT BEAR LAKE PHASE 7A

LOCATED IN THE NORTHWEST 1/4 OF SECTION 21, TOWNSHIP 14 NORTH, RANGE 5 EAST, SLB&M,  
GARDEN CITY, RICH COUNTY, UTAH

PROJECT  
C19-027  
SHEET  
6 OF 7  
ISSUE DATE  
02/14/2022

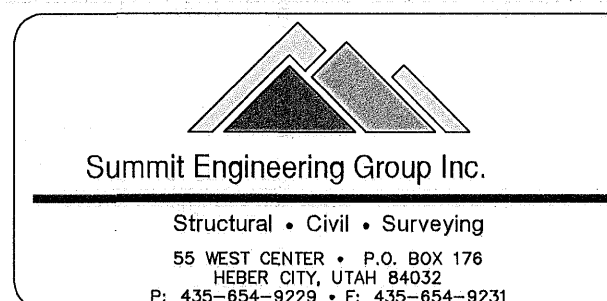

COPYRIGHT © 2022  
SUMMIT ENGINEERING GROUP, INC.  
DRAWING ALTERATION  
IT IS A VIOLATION OF LAW FOR ANY PERSON, UNLESS ACTING UNDER THE DIRECTION OF THE PROFESSIONAL LAND SURVEYOR TO ALTER ANY ITEM ON THIS DOCUMENT IN ANY MANNER. ANY LICENSEE WHO ALTERS THIS DOCUMENT IS REQUIRED BY LAW TO AFFIX THEIR SEAL AND THE NOTATION "ALTERED BY" FOLLOWED BY THEIR SIGNATURE AND EXACT DESCRIPTION OF THE ALTERATIONS.