

LAKE RESIDENCES AT BEAR LAKE PHASE 7A

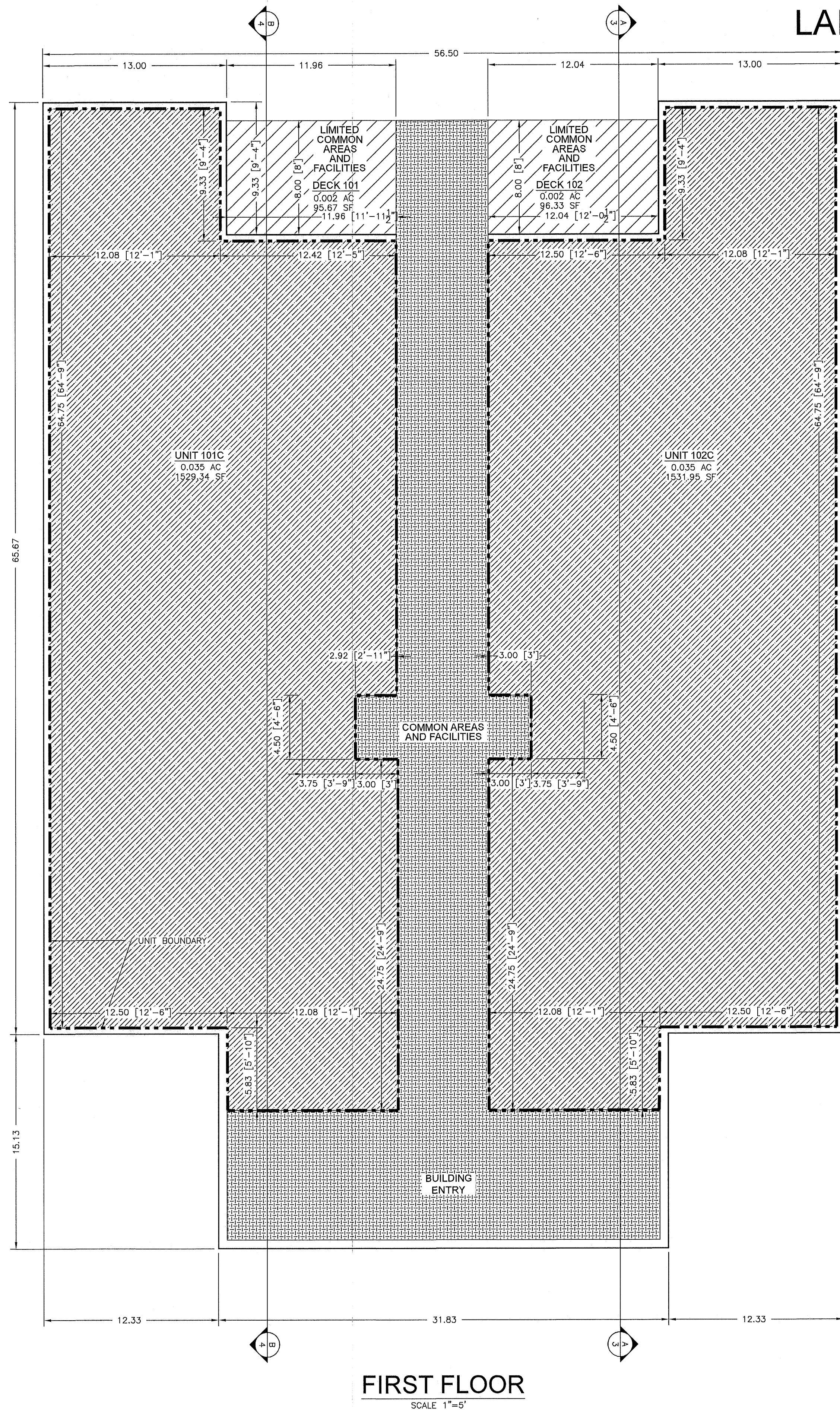

FIRST FLOOR
SCALE 1"=5'

LEGEND

	UNIT BOUNDARY
	COMMON AREAS AND FACILITIES* / WITHDRAWABLE LAND
	LIMITED COMMON AREAS AND FACILITIES / WITHDRAWABLE LAND
	CONVERTIBLE SPACE / WITHDRAWABLE LAND
	PRIVATE SPACE / WITHDRAWABLE LAND

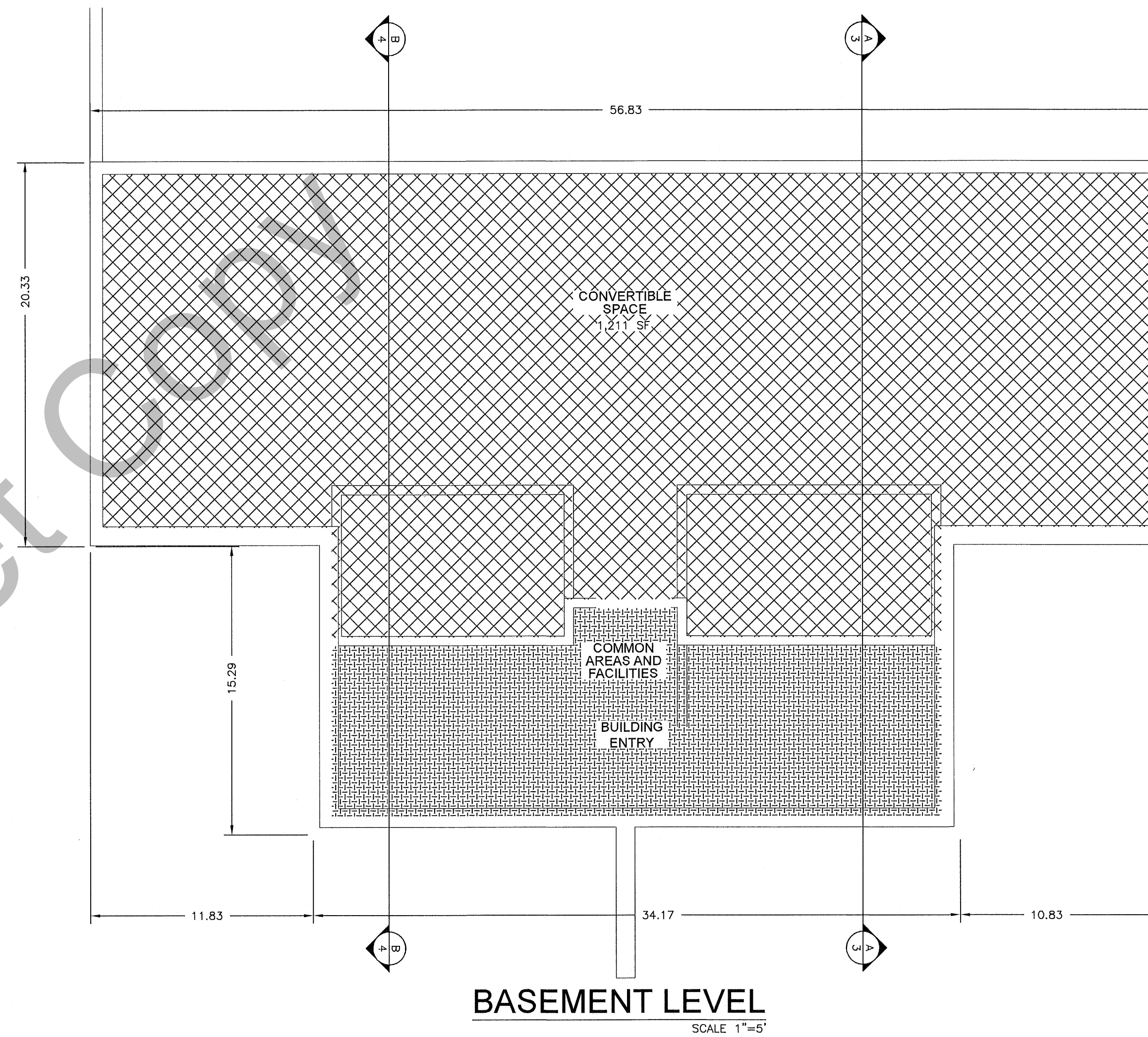

BASEMENT LEVEL
SCALE 1"=5'

PROJECT
C19-027
SHEET
5 OF 7
ISSUE DATE
02/14/2022

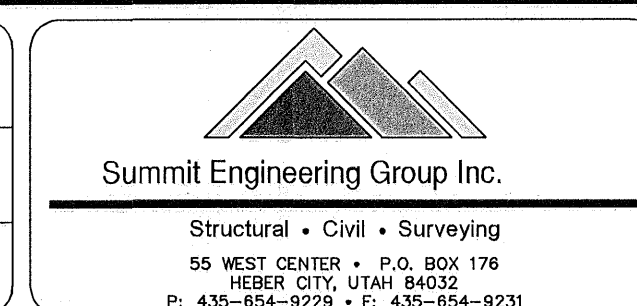

COPYRIGHT © 2022
SUMMIT ENGINEERING GROUP, INC.
DRAWING ALTERATION:
IT IS A VIOLATION OF LAW FOR ANY PERSON, UNLESS AUTHORIZED UNDER THE SUPERVISION OF THE PROFESSIONAL ENGINEER OR ARCHITECT, TO ALTER ANY ITEM ON THIS DOCUMENT IN ANY WAY. ANY LICENSEE WHO ALTERS THIS DOCUMENT IS REQUIRED BY THEIR SIGNATURE AND SPECIFIC DESCRIPTION OF THE ALTERATIONS.

LAKE RESIDENCES AT BEAR LAKE PHASE 7A

LOCATED IN THE NORTHWEST ¼ OF SECTION 21, TOWNSHIP 14 NORTH, RANGE 5 EAST, SLB&M, GARDEN CITY, RICH COUNTY, UTAH