

BLUEWATER RESORT CONDOMINIUMS

A PART OF THE SOUTHEAST QUARTER OF
SECTION 33, TOWNSHIP 15 NORTH, RANGE 5 EAST S.L.B.&M.
GARDEN CITY, RICH COUNTY, UTAH
APRIL 2004

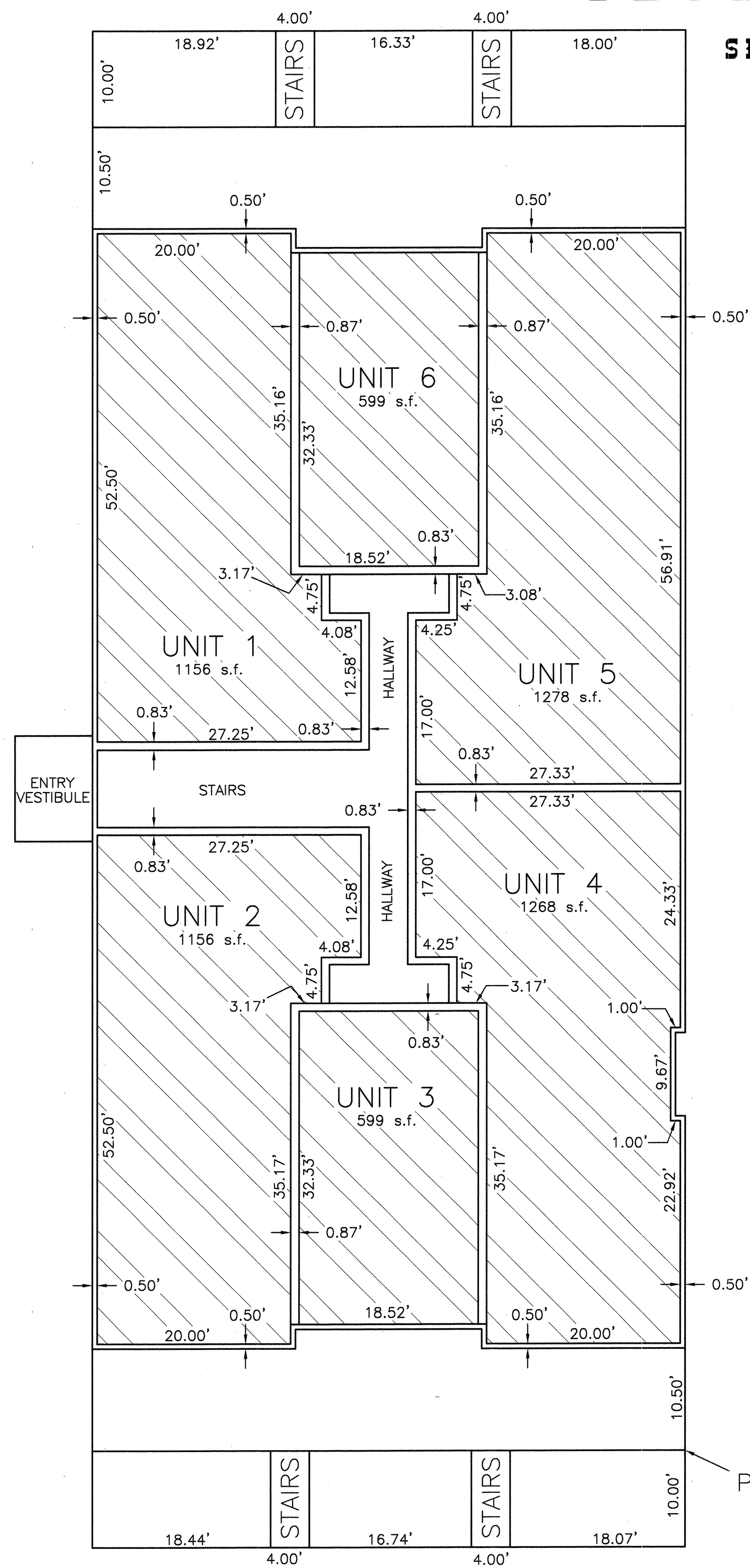

PAGE 2 OF 3 LOWER FLOOR PLAN

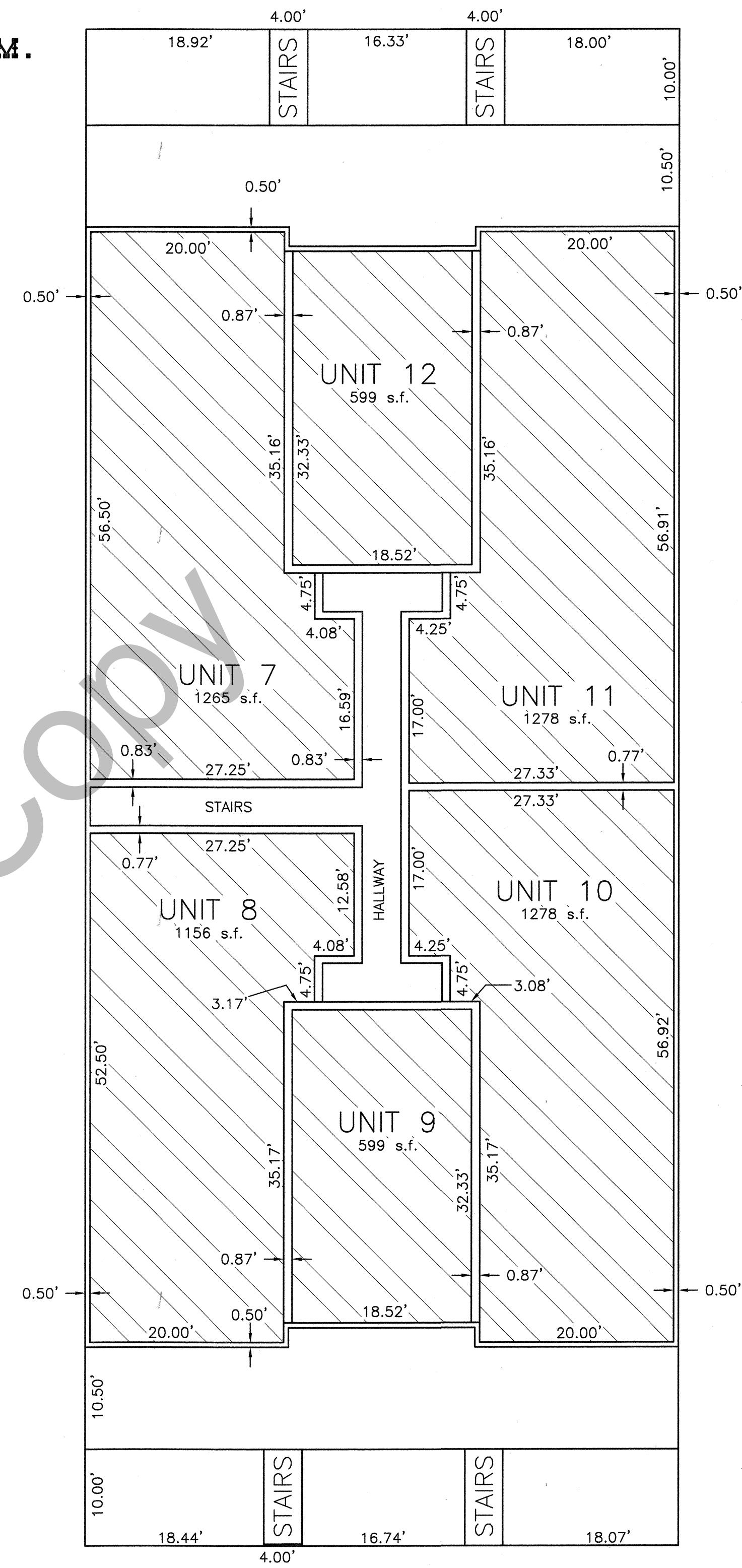

UPPER FLOOR PLAN

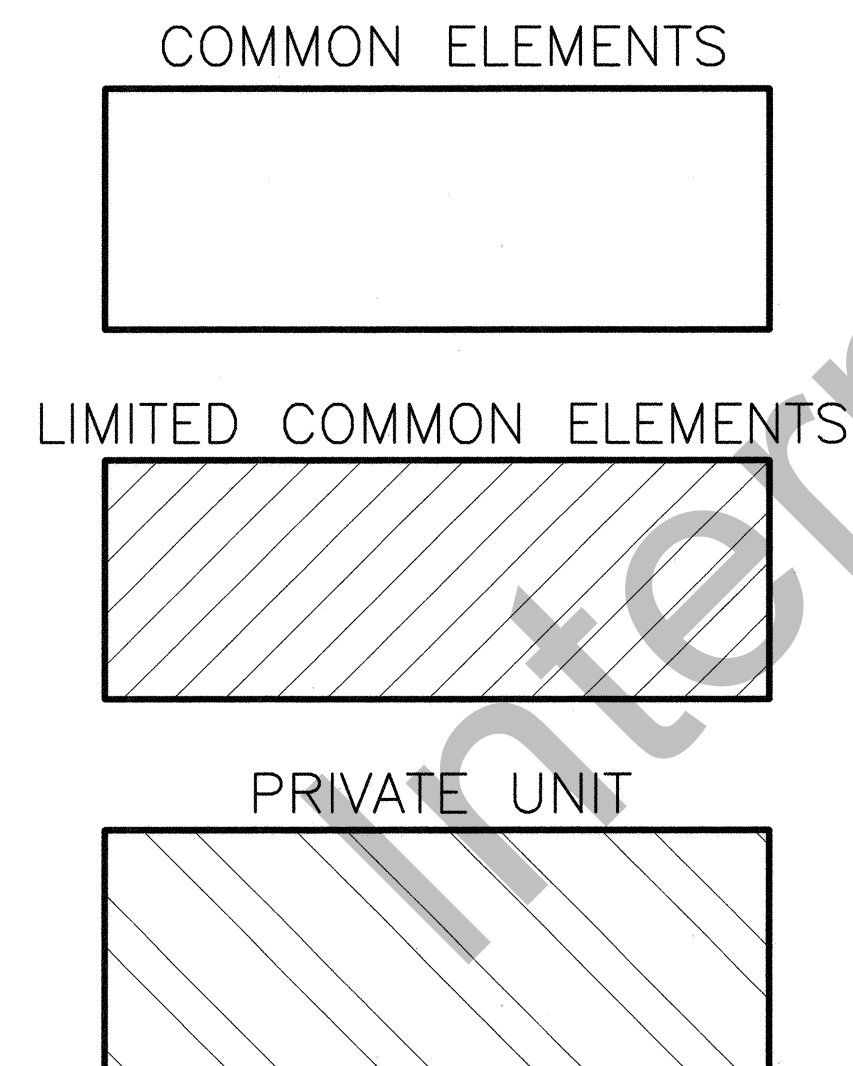

BENCH MARK IS
DEPT. OF NATURAL RESOURCES
BEAR LAKE CONTROL NETWORK
GPS MONUMENT #BL13
U.P.&L. DATUM 5946.42

SCALE = 1" = 10'

P.O.B. LOCATION