

RICH COUNTY
 SECTION 6 T. 14 N. R. 8 E., S.L.B. & M.

44-06-000-PARCEL

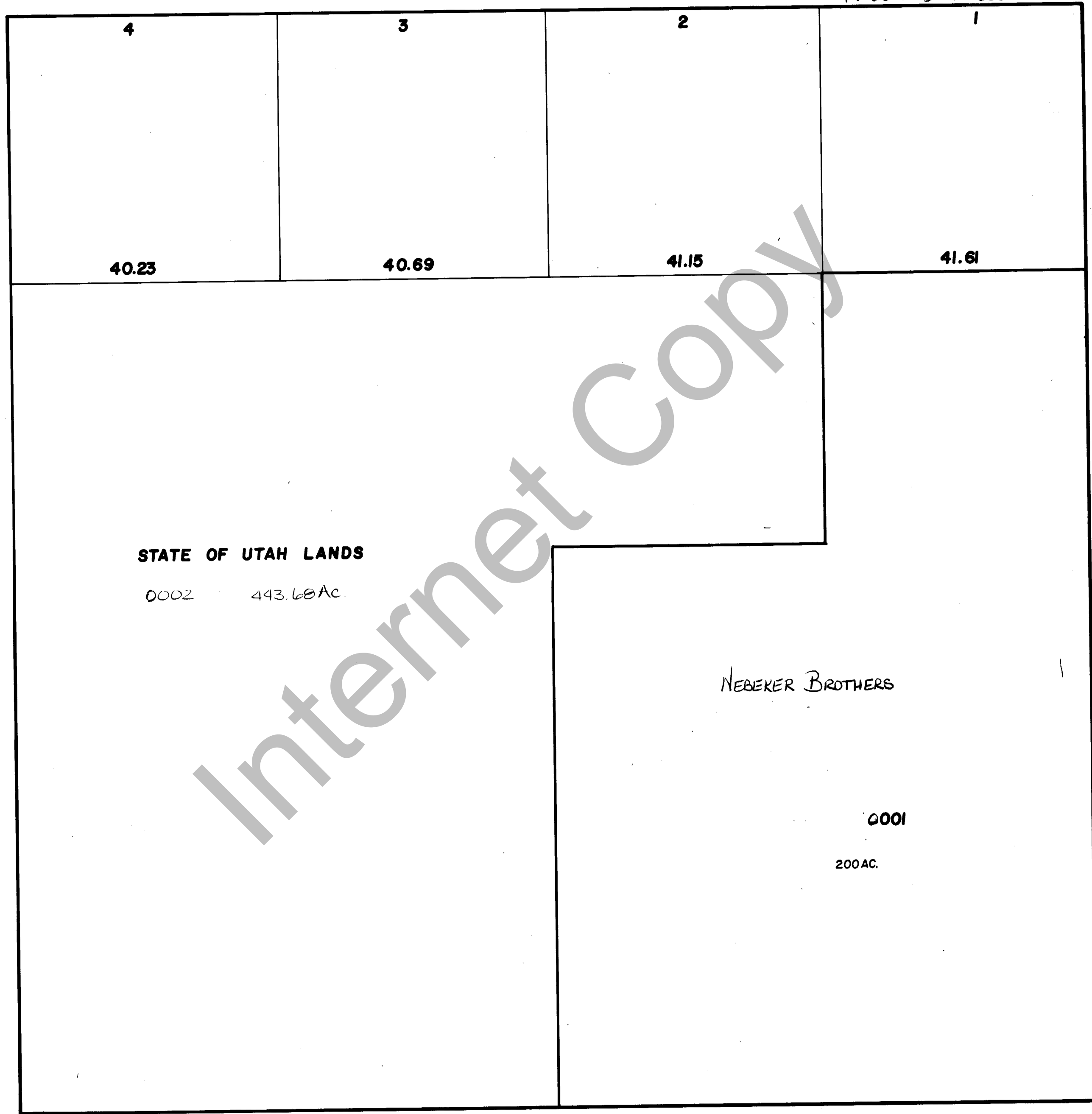

STATE OF UTAH LANDS

0002 443.68 AC.

NEBEKER BROTHERS

0001

200 AC.

40.23

40.69

41.15

41.61

Internet Copy

REVISIONS	

THIS PLAT IS MADE SOLELY FOR THE PURPOSE OF ASSISTING IN LOCATING THE LAND, AND THE RECORDER ASSUMES NO LIABILITY FOR VARIATIONS, IF ANY, WITH AN ACTUAL SURVEY.

Section 6 T. 14 N. R. 8 E.
 drawn by MVH date 11-80

book _____ page _____
 scale 1" = 400'