

RICH COUNTY  
SECTION 22 , T 14 N. R 7 E, S. LB & M

SERIAL NO = 43-22-000 PARCEL

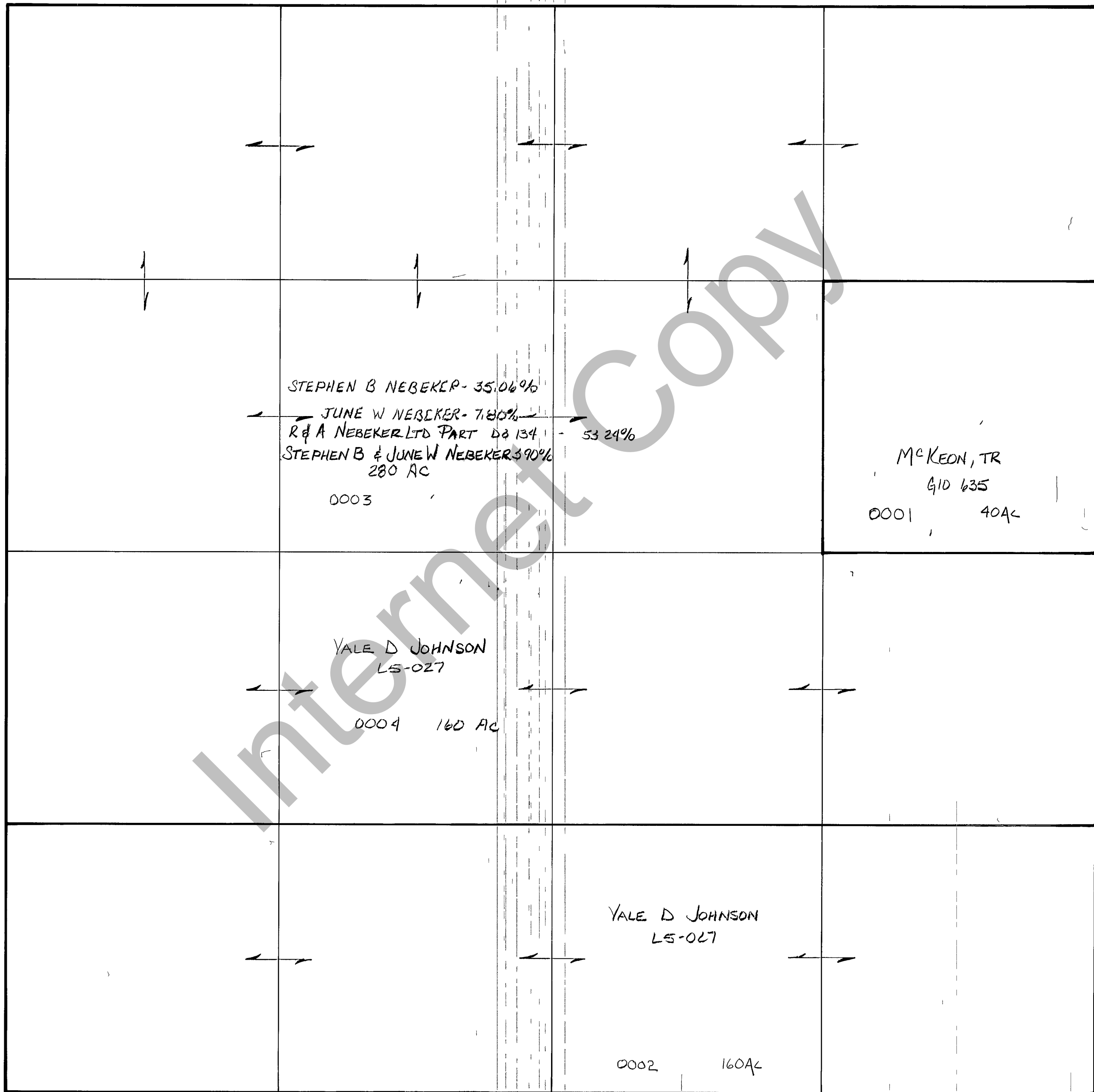

REVISIONS	

THIS PLAT IS MADE SOLELY FOR THE PURPOSE OF ASSISTING IN LOCATING THE LAND AND TO BE RECORDED AS SUCH WITHOUT LIABILITY FOR VARIATION IF ANY ACTUAL SURVEY

Section 22 T 14 N. R 7E

drawn by DW date 2-80

book \_\_\_\_\_ page \_\_\_\_\_

scale 1" = 400'