

RICH COUNTY
SECTION 11 T. 14 N. R. 7 E., S.L.B. & M.

43-11-000-PARCEL

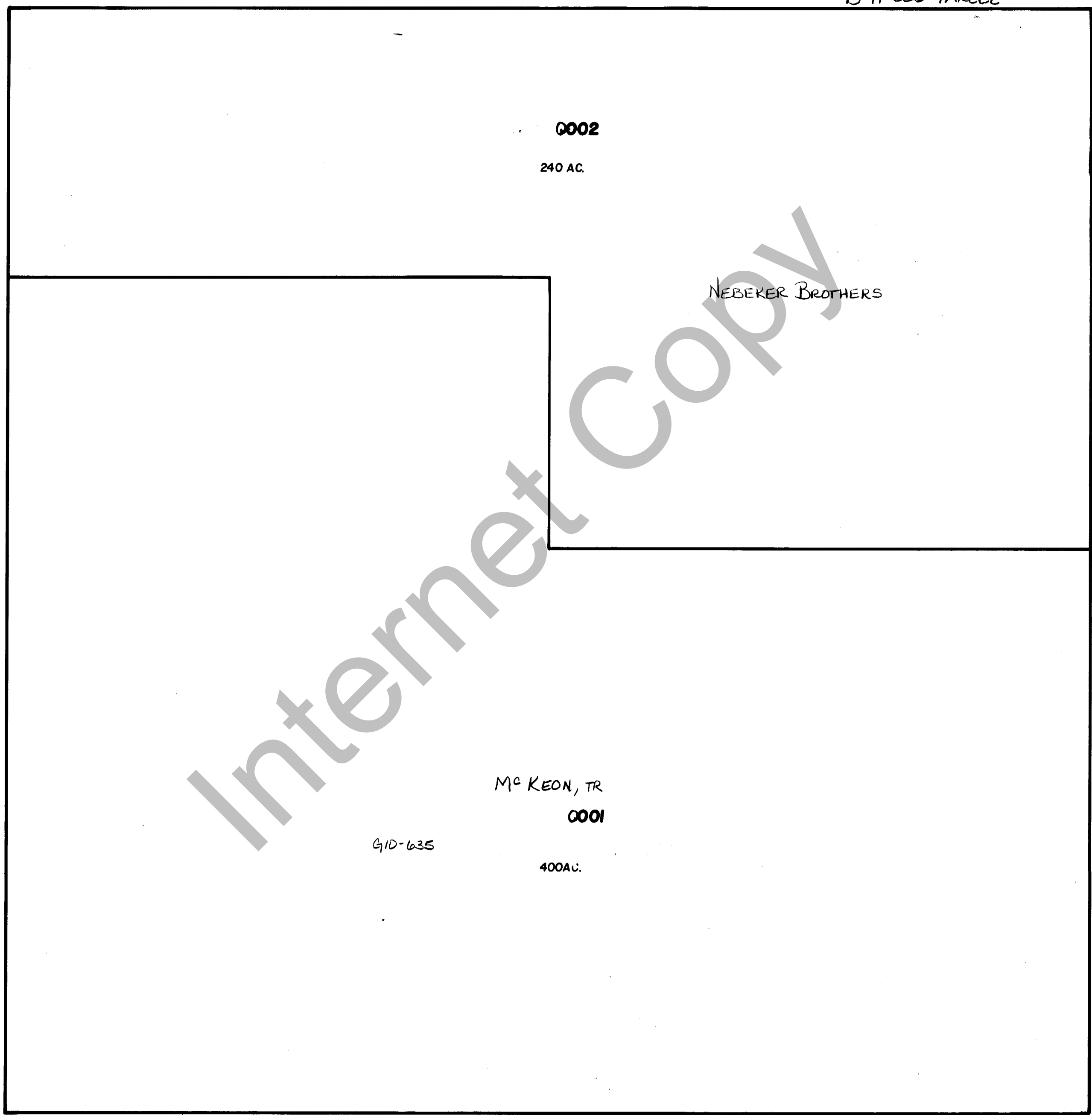

0002

240 AC.

NEBEKER BROTHERS

Mc KEON, TR

0001

400 AC.

G10-635

REVISIONS		

THIS PLAT IS MADE SOLELY FOR THE PURPOSE OF ASSISTING IN LOCATING THE LAND, AND THE RECORDER ASSUMES NO LIABILITY FOR VARIATIONS, IF ANY, WITH AN ACTUAL SURVEY.

Section 11 T. 14 N. R. 7 E.

book page

drawn by MVH date 11-80

scale 1"=400