

RICH COUNTY
SECTION 34 , T 14 N. R 6 E, SLB&M

SERIAL NO= 42-34-000-PARCEL

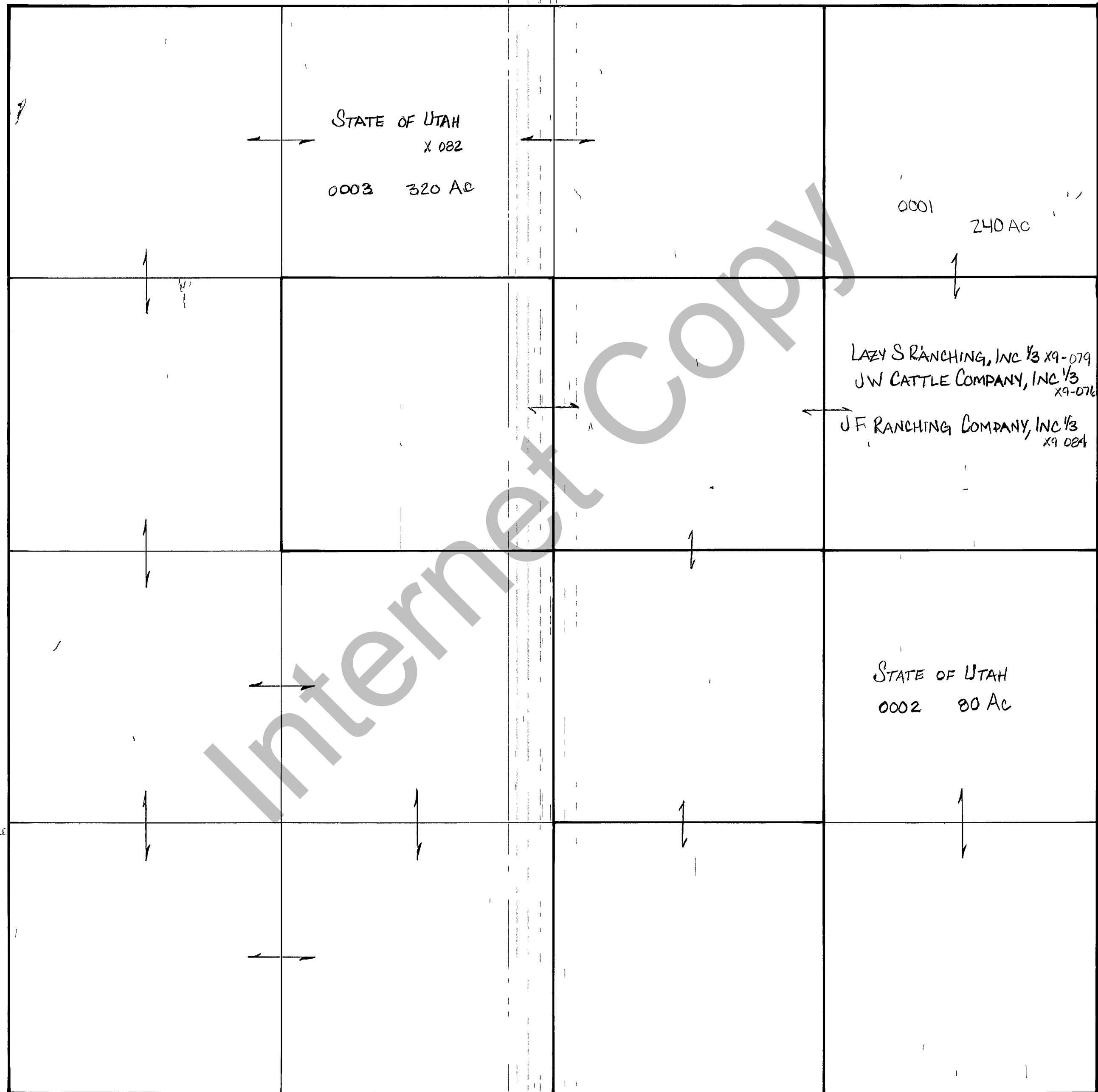

REVISIONS		

THIS PLAT IS MADE SOLELY FOR THE PURPOSE OF ASSISTING IN LOCATING THE LAND AND THE RECORD AS SHOWN ON THE SURVEY AND IS NOT TO BE CONSIDERED AN ACTUAL SURVEY.

Section 34 T 14 N. R 6 E

drawn by DW date 3-80

book page
scale 1" = 400'