

SCALE 1 INCH = 100 FEET

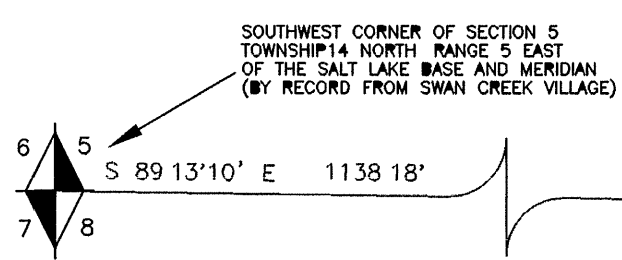

# CREEKSIDE SUBDIVISION

PART OF THE NORTH HALF OF THE SOUTHWEST QUARTER OF SECTION 5,  
 TOWNSHIP 14 NORTH, RANGE 5 EAST, OF THE SALT LAKE BASE AND MERIDIAN



41-05-020-LTS

REVISIONS _____ _____ _____	CREEKSIDE SUBDIVISION	SECTION 5 T 14 N, R 5 E SLB & M	SCALE 1"=100'
--------------------------------------	--------------------------	---------------------------------------	------------------