

RICH COUNTY
SECTION 15 , T. 13 N.R. 7 E., S.L.B.&M.

SERIAL NO. = 38-15-000-PARCEL

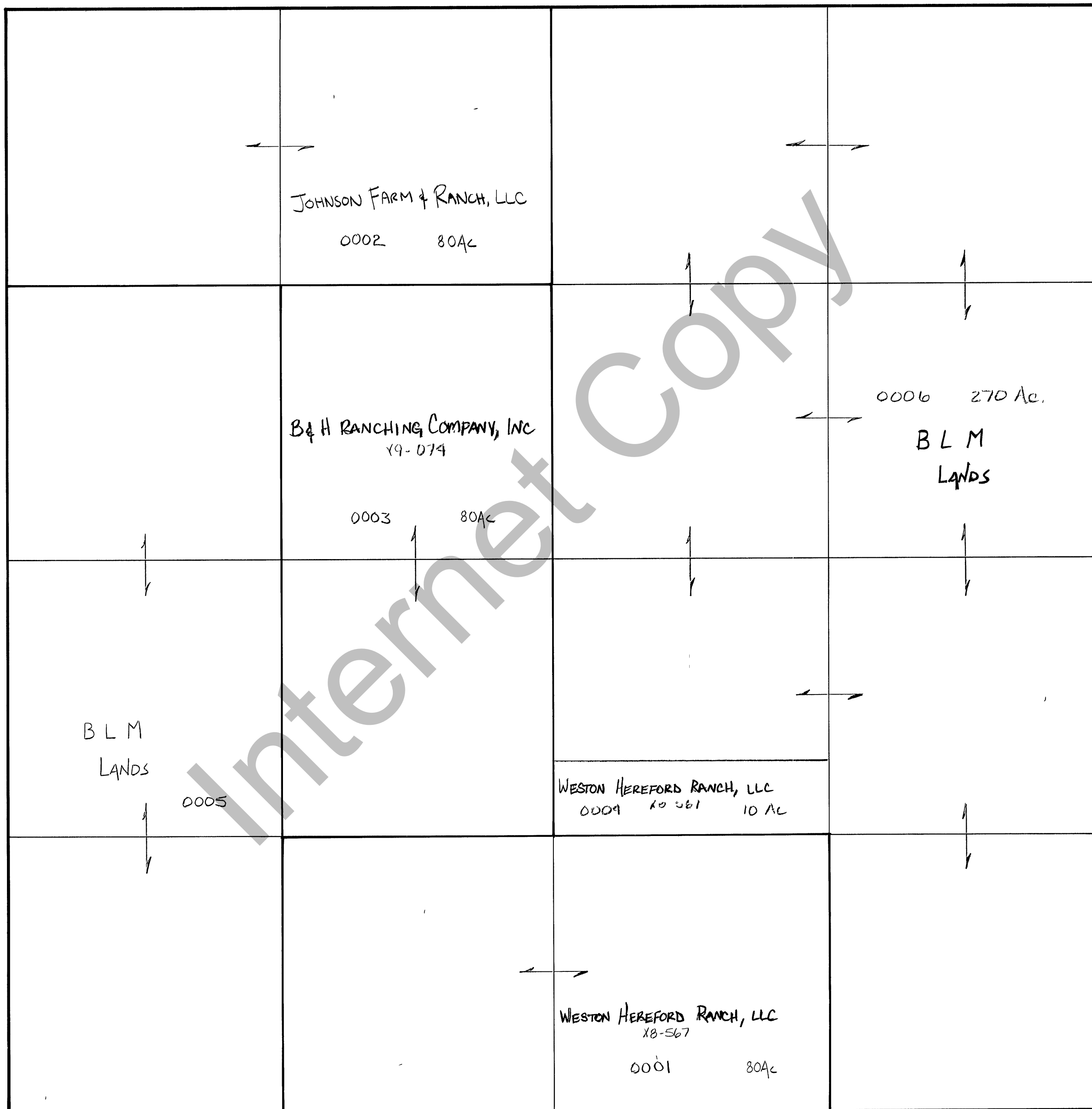

REVISIONS		

THIS PLAT IS MADE SOLELY FOR THE PURPOSE OF ASSISTING IN LOCATING THE LAND, AND THE RECORDER ASSUMES NO LIABILITY FOR VARIATIONS, IF ANY, WITH AN ACTUAL SURVEY

Section <u>15</u> T <u>13N</u> R <u>7E</u>		book page
drawn by DW	date 12-79	scale 1"=400'