

RICH COUNTY
 SECTION 34 , T 13 N. R 6 E, SLB&M

SERIAL NO = 37-34-000-PARCEL

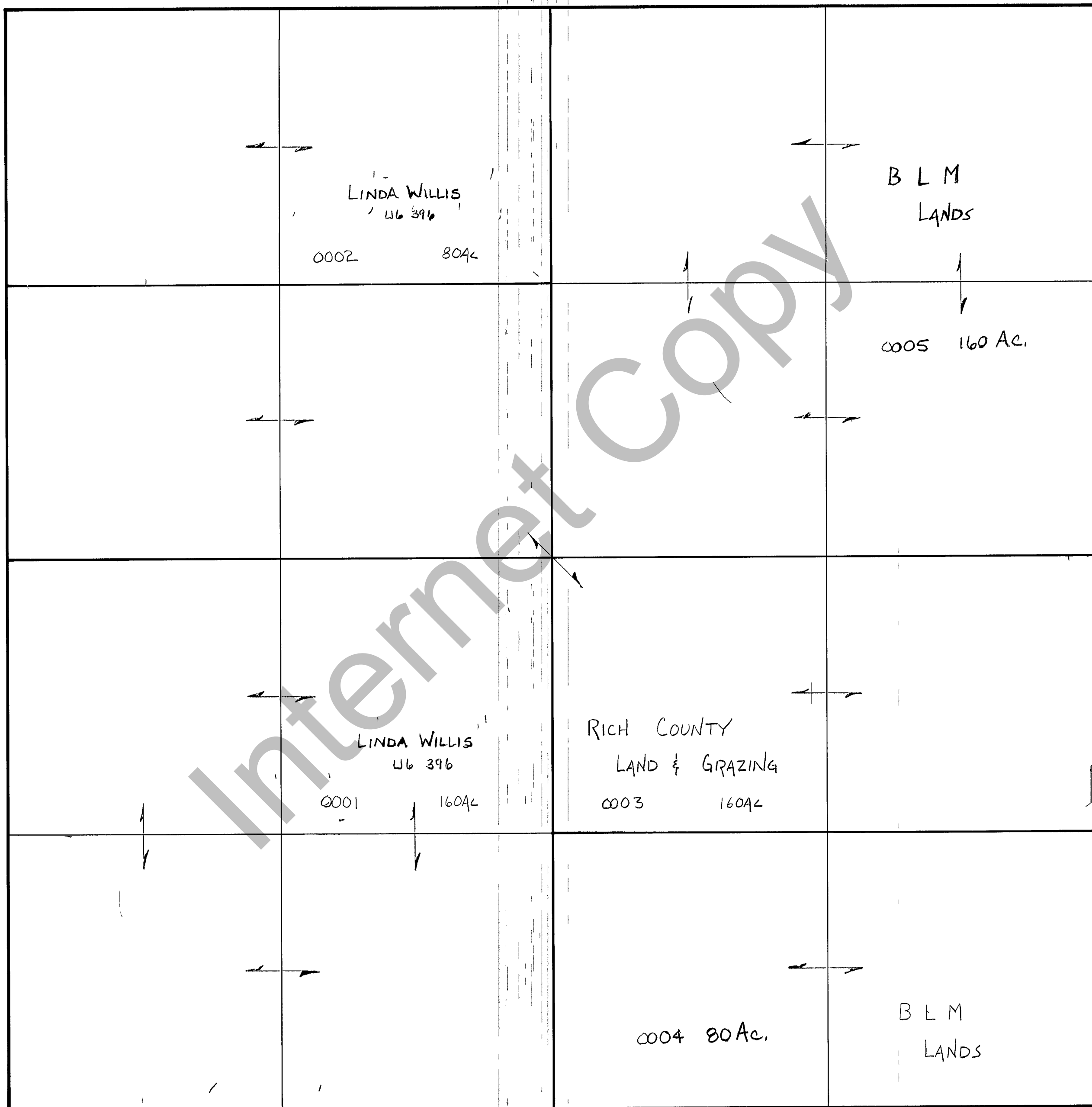

REVISIONS			THIS PLAT IS MADE SOLELY FOR THE PURPOSE OF ASSISTING IN LOCATING THE LAND AND THE RECORDER ASSUMES NO LIABILITY FOR VARIATIONS IF ANY WITH AN ACTUAL SURVEY	Section <u>34</u> T <u>13</u> N. R <u>6E</u>		book	page
				drawn by <u>DW</u>	date <u>1-80</u>	scale <u>1"=400'</u>	

TMS