

RICH COUNTY

SECTION 16 , T. 13 N.R. 6 E., S.L.B.&M.

37-16-000-PARCEL

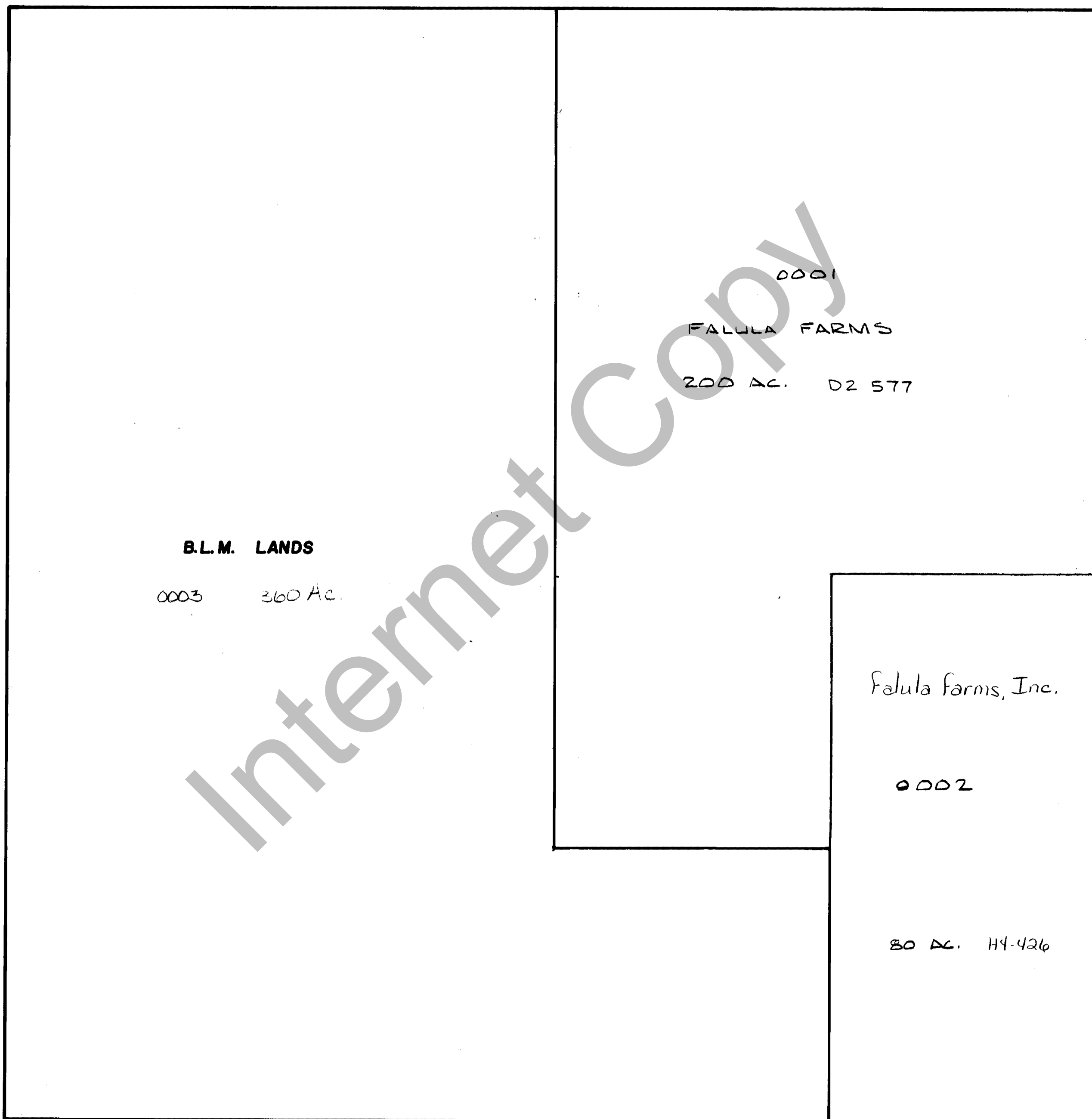

B.L.M. LANDS

0003 360 AC.

0001

FALULA FARMS

200 AC. D2 577

Falula Farms, Inc.

0002

80 AC. H4-426

REVISIONS		

THIS PLAT IS MADE SOLELY FOR THE PURPOSE OF ASSISTING IN LOCATING THE LAND, AND THE RECORDER ASSUMES NO LIABILITY FOR VARIATIONS, IF ANY, WITH AN ACTUAL SURVEY.

Section 16 T. 13 N. R. 6 E.

book \_\_\_\_\_ page \_\_\_\_\_

drawn by MVH date 11-80

scale 1"=400'