

RICH COUNTY
 SECTION 29 , T. 12 N. R. 5 E., S.L.B. & M.

SERIAL NO = 31-29-000 = Parcel

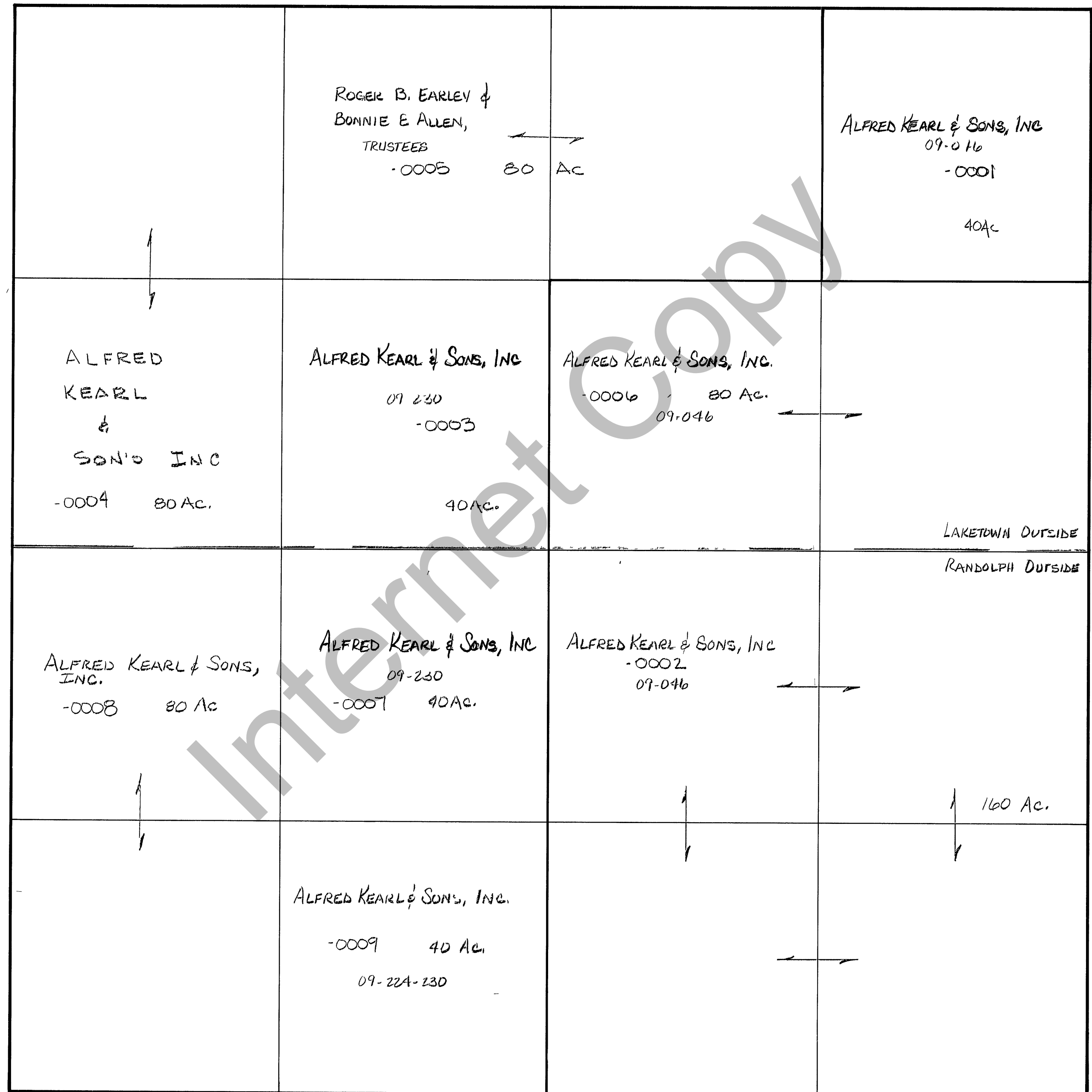

REVISIONS		

THIS PLAT IS MADE SOLELY FOR THE PURPOSE OF ASSISTING IN LOCATING THE LAND, AND THE RECORDER ASSUMES NO LIABILITY FOR VARIATIONS IF ANY, WITH AN ACTUAL SURVEY.

Section <u>29</u> T <u>12</u> N R <u>5E</u>		book _____ page _____
drawn by <u>DW</u>	date <u>12-79</u>	scale <u>1"=400'</u>