

RICH COUNTY  
SECTION 23 T. 12 N. R. 5 E., S.L.B. & M.

31-23-000-PARCEL

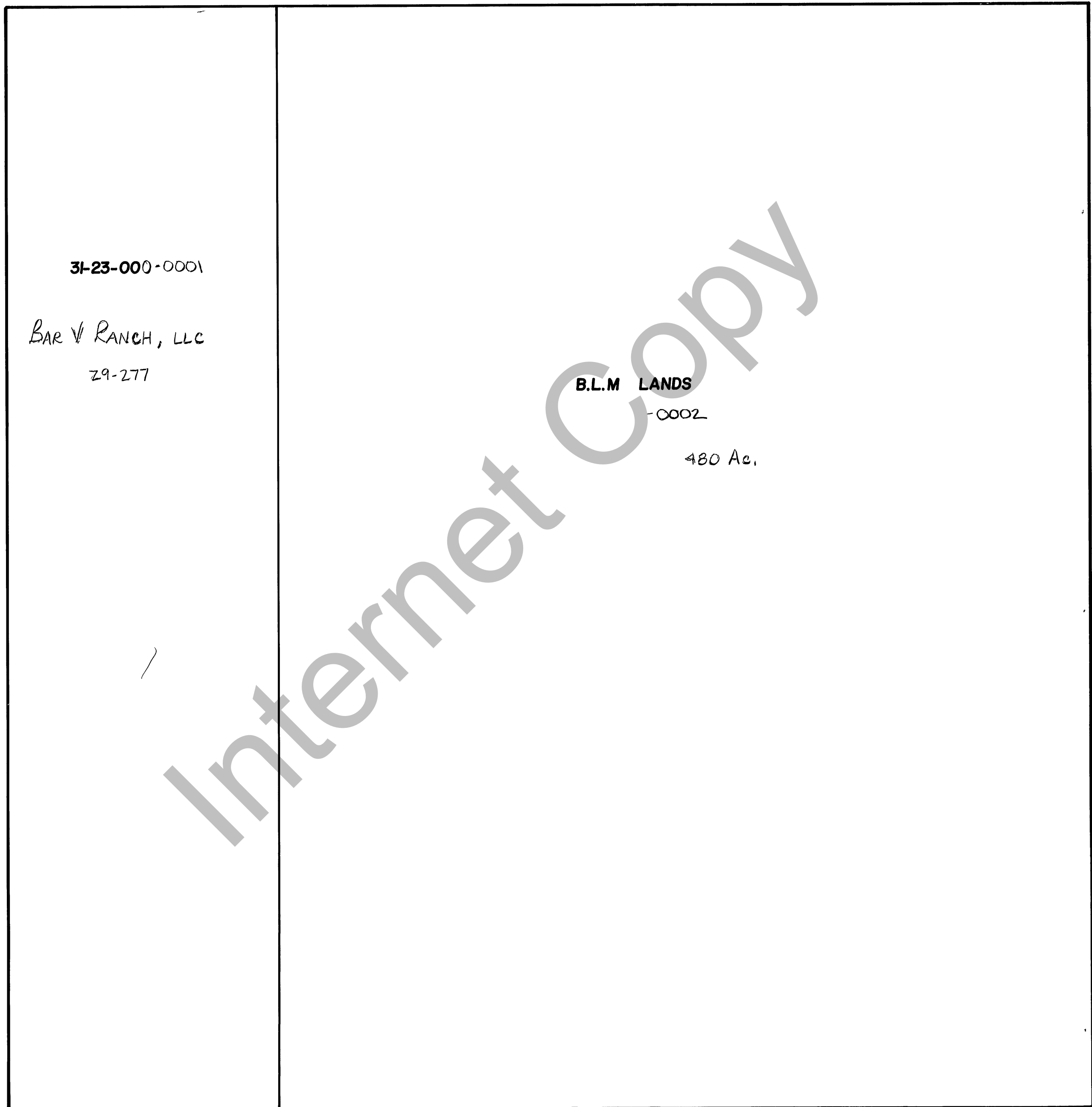

31-23-000-0001

BAR V RANCH, LLC

29-277

B.L.M LANDS

-0002

480 Ac.

Internet Copy

REVISIONS		

THIS PLAT IS MADE SOLELY FOR THE PURPOSE OF ASSISTING IN LOCATING THE LAND, AND THE RECORDER AS ~~MAKES~~ NO LIABILITY FOR VARIATIONS IF ANY, WITH AN ACTUAL SURVEY

Section 23 T 12 N R 5 E

book " " page " "

drawn by MVH date 11-80

scale 1"=400'