

RICH COUNTY

SECTIONS  
14, 15, 22, 23

T. 10 N. R. 7 E., S. L. B. & M.

24-SEC-000-PARCEL

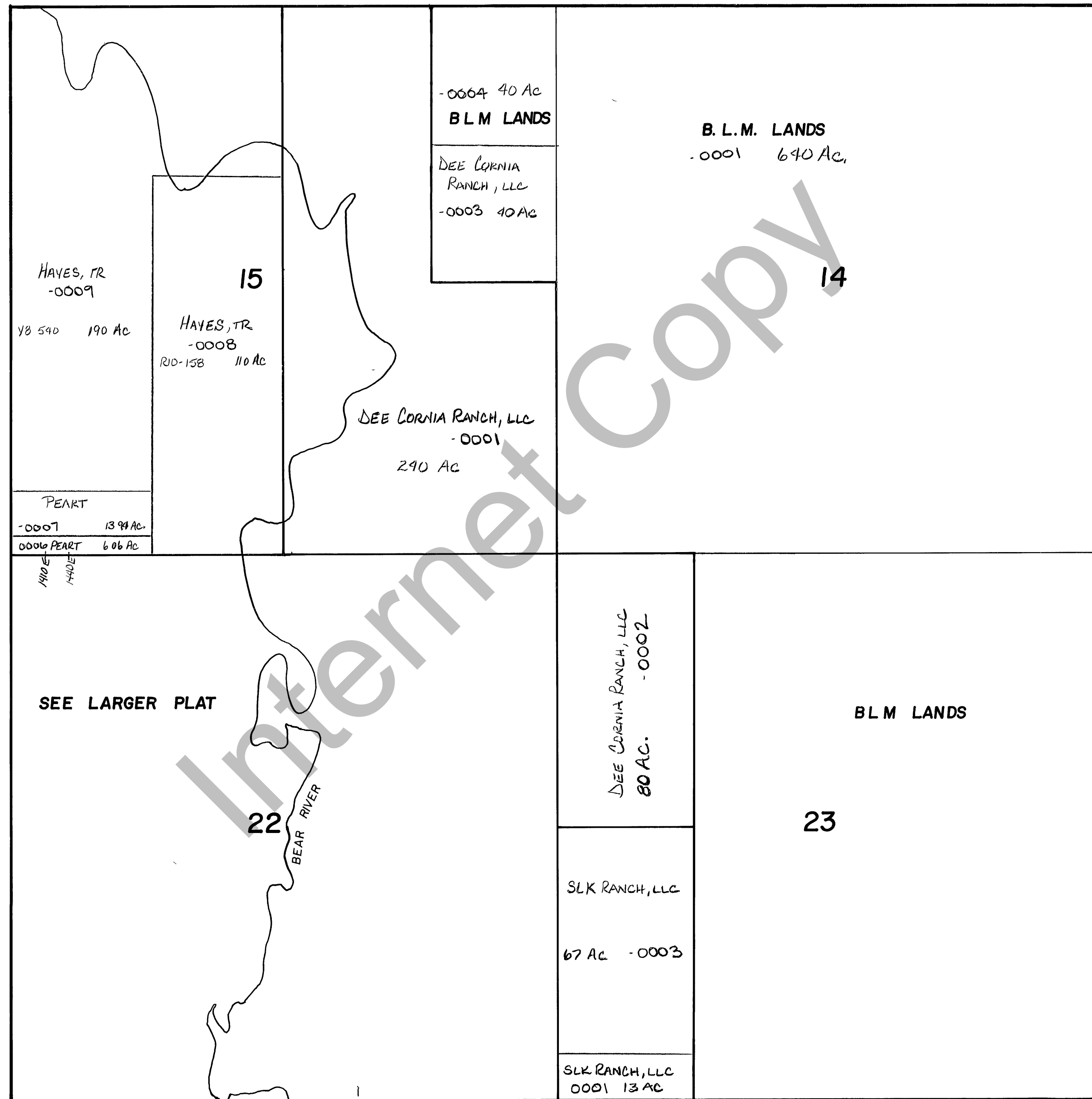

REVISIONS	

THIS PLAT IS MADE SOLELY FOR THE PURPOSE OF ASSISTING IN LOCATING THE LAND, AND THE RECORDER ASSUMES NO LIABILITY FOR VARIATIONS IF ANY, WITH AN ACTUAL SURVEY

1514  
Section 22, 23 T. 10 N. R. 7 E.  
drawn by MVH date 11-80

book page  
scale 1" = 800'