

RICH COUNTY  
 T.10N.R.6E.,S.L.B.&M.

SERIAL NO = 23-SEC-000-PARCEL

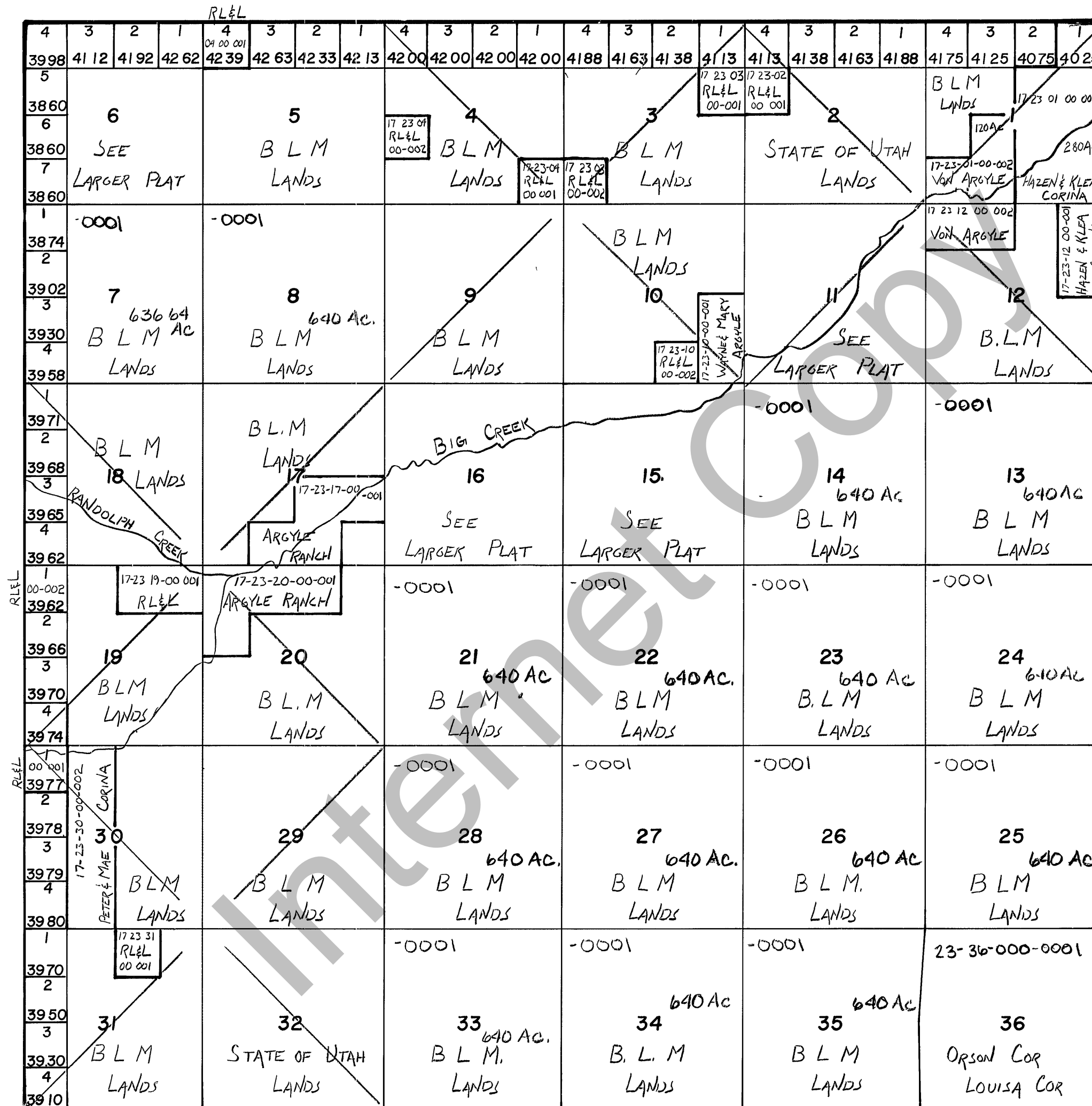

RL&L = RANDOLPH LAND & LIVESTOCK CO

REVISIONS	

THIS PLAT IS MADE SOLELY FOR THE PURPOSE OF ASSISTING IN LOCATING THE LAND, AND THE RECORDER ASSUMES NO LIABILITY FOR VARIATIONS IF ANY, WITH AN ACTUAL SURVEY

Section \_\_\_\_\_ T 10N R 6E

book \_\_\_\_\_ page \_\_\_\_\_

drawn by DW date 11-79

scale 1"=3000'