

RICH COUNTY
 SECTION $\frac{29}{32} \frac{28}{33}$ T. 10 N. R. 5 E., S.L.B. & M.

SERIAL NO., 22-SEC-000-PARCEL

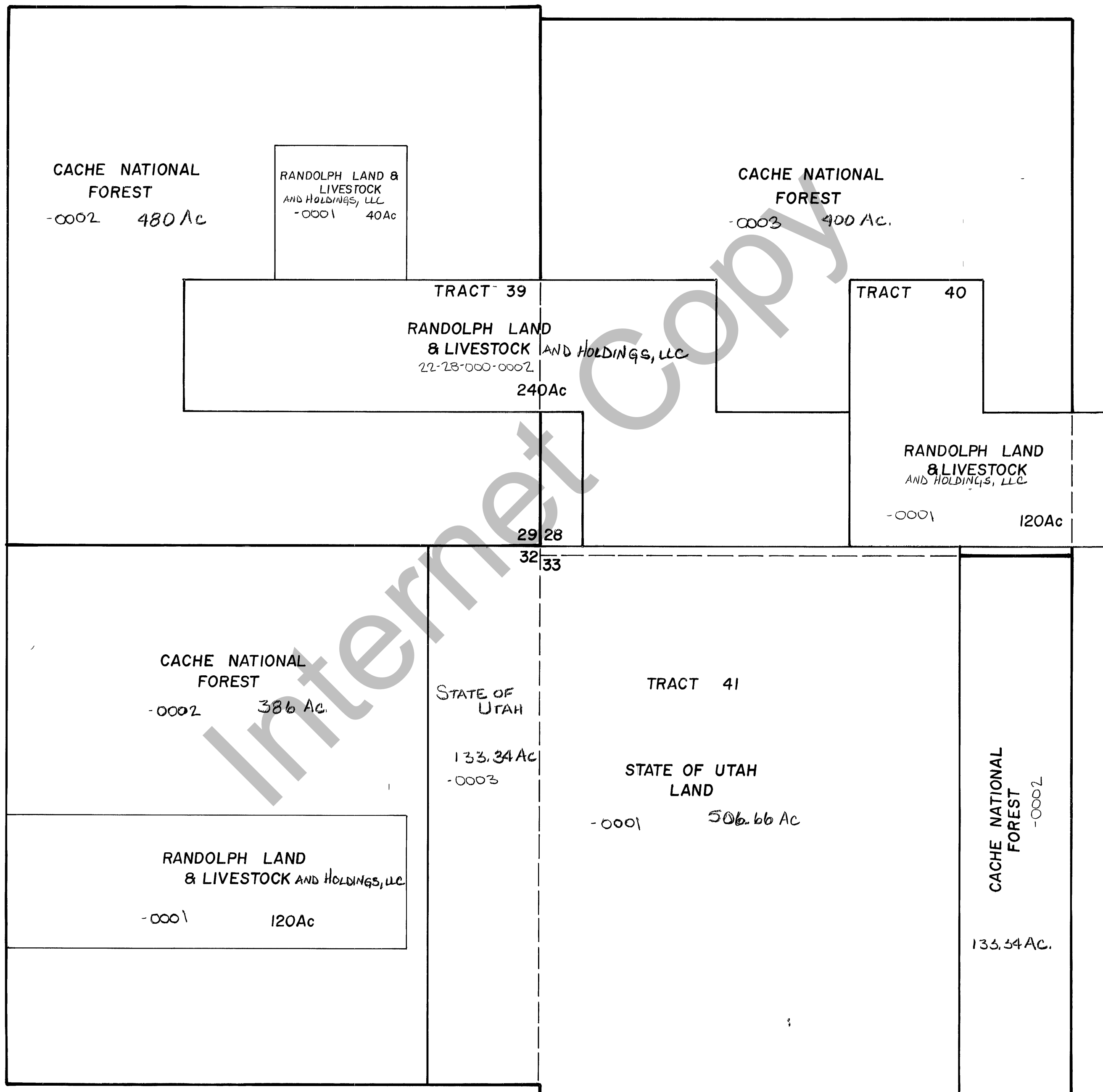

REVISIONS		

THIS PLAT IS MADE SOLELY FOR THE PURPOSE OF ASSISTING IN LOCATING THE LAND, AND THE RECORDER ASSUMES NO LIABILITY FOR ERRORS IF ANY, WITH A FEW EXCEPTIONS.

Section $\frac{29}{32} \frac{28}{33}$ T 10 N R 5 E

book page

drawn by DRW date 7-80

scale 1" = 800'