

RICH COUNTY
SECTION 25, T. 10 N. R. 5 E., S.L.B. & M.

SERIAL NO = 22-25-000-PARCEL

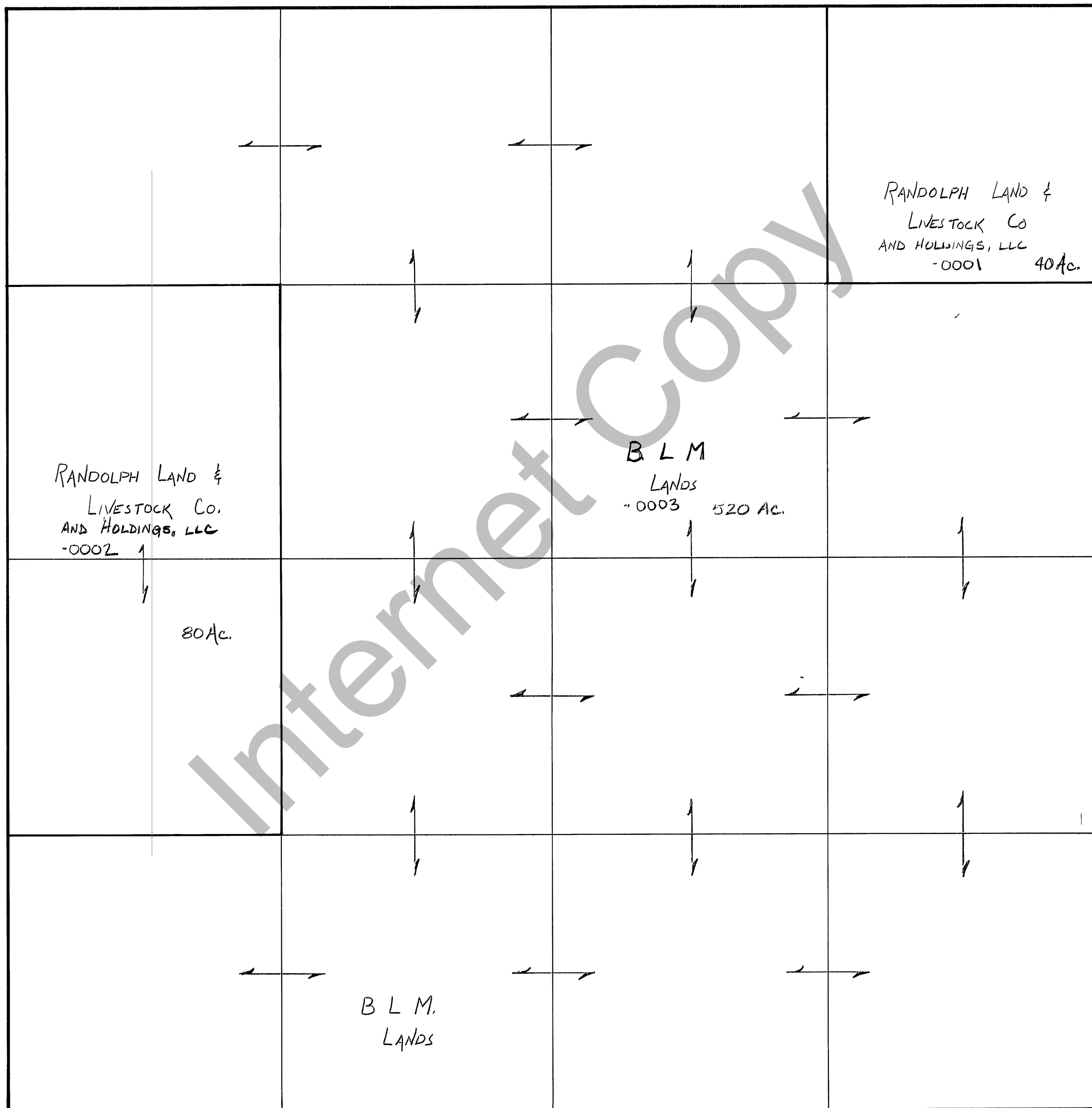

REVISIONS		

THIS PLAT IS MADE SOLELY FOR THE PURPOSE OF ASSISTING IN LOCATING THE LAND, AND THE RECORDER ASSUMES NO LIABILITY FOR VARIATIONS, IF ANY, WITH AN ACTUAL SURVEY.

Section 25 T 10 N R 5 E

book page

drawn by DW date 11-79

scale 1"=400'