

RICH COUNTY
SECTION 33 T. 9 N. R. 7 E., S.L.B. & M.

SERIAL NO. 19-33-000-PARCEL

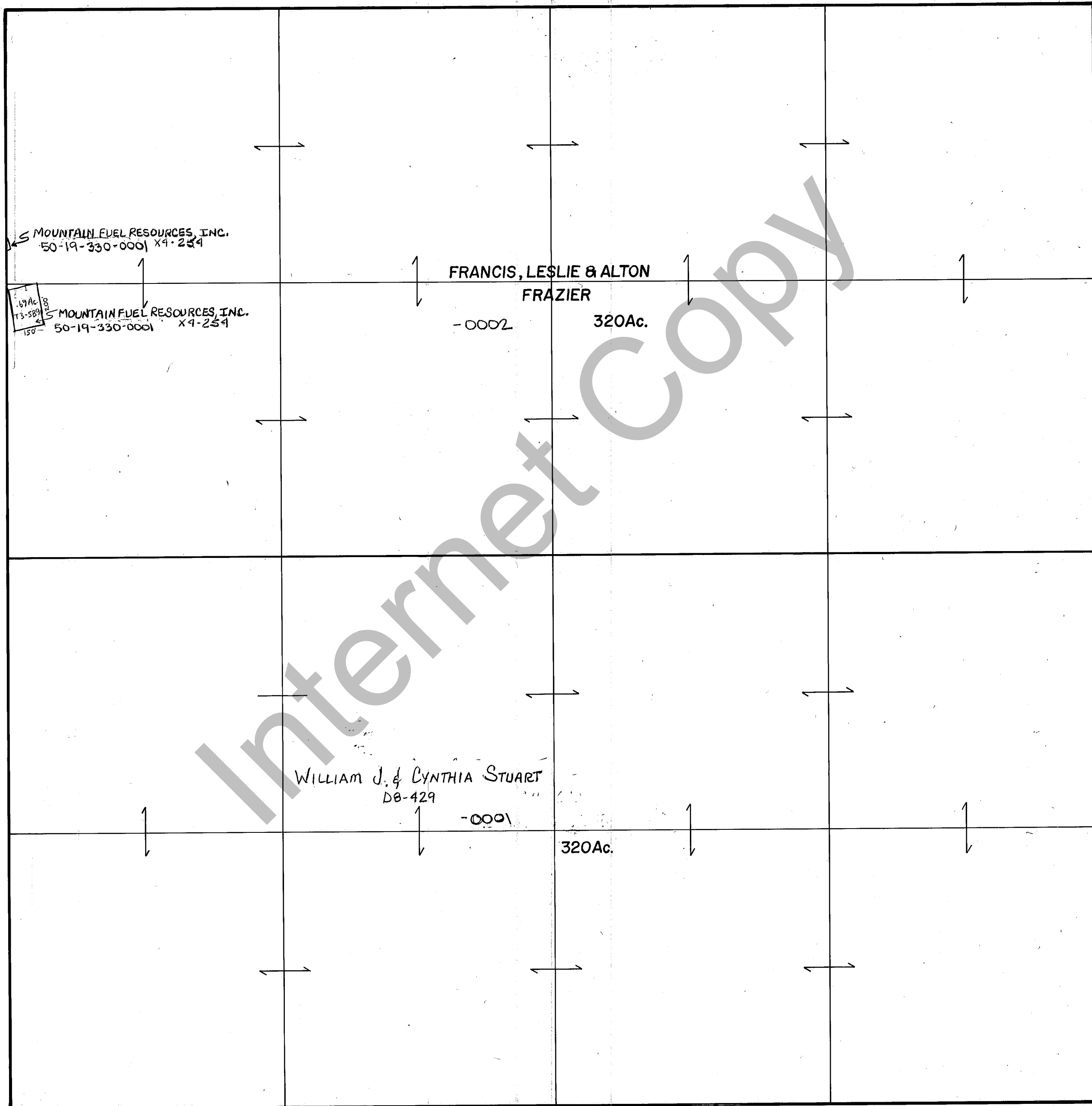

Internet Copy

REVISIONS		

THIS PLAT IS MADE SOLELY FOR THE PURPOSE OF ASSISTING IN LOCATING THE LAND, AND THE RECORDER ASSUMES NO LIABILITY FOR VARIATIONS, IF ANY, WITH AN ACTUAL SURVEY.

Section 33 T. 9N. R. 7E.

book page

drawn by DRW date 6-80

scale 1"=400'