

RICH COUNTY
SECTION 20, T 9 N, R 6 E, S. 1 B & M

SERIAL NO = 18-20-000-PARCEL

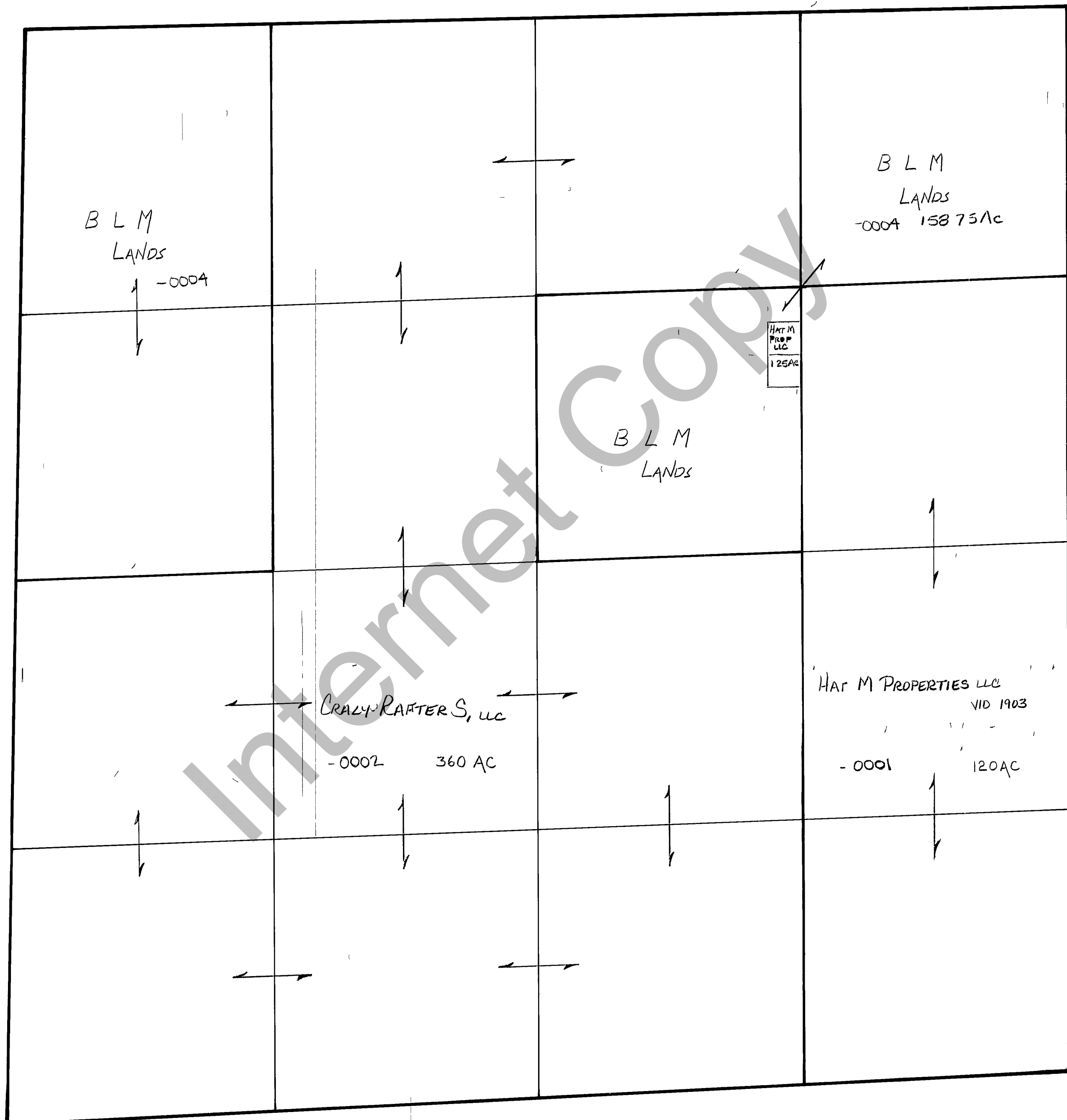

REVISIONS		

THIS PLAT IS MADE SOLELY FOR THE
PURPOSE OF ASSISTING IN LOCATING
THE LAND AND THE RECORDER AS
SUMES NO LIABILITY FOR VARIATIONS
IF ANY WITH AN ACTUAL SURVEY

Section 20 T 9 N, R 6 E

book page

drawn by DW

date 11-79

scale 1"=400'