

RICH COUNTY

SECTION  $\frac{17}{20} \frac{16}{21}$  T 8 N. R 6 E, S. LB & M

SERIAL NO 13-SEC-000-PARCEL

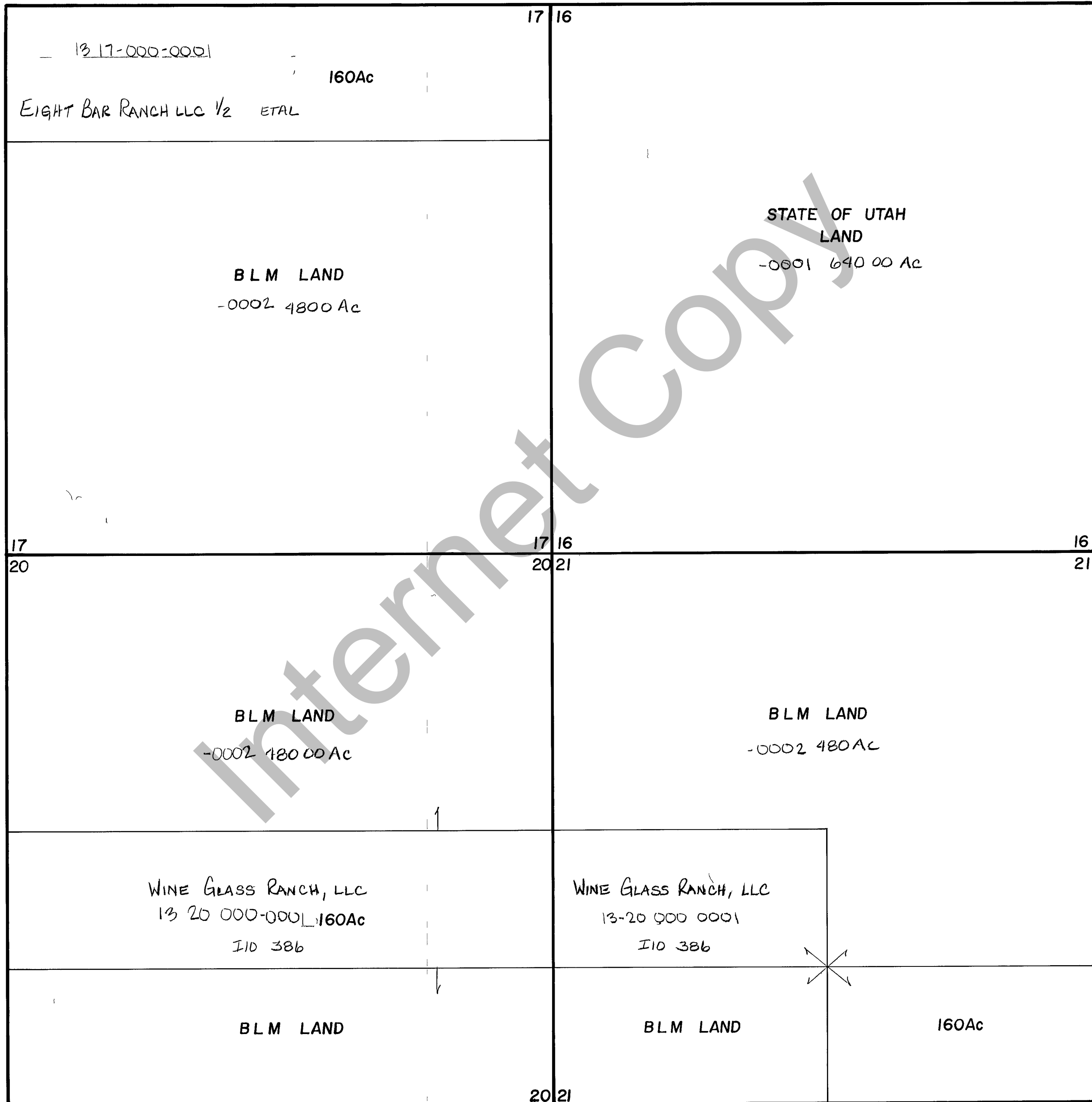

REVISIONS		

THIS PLAT IS MADE SOLELY FOR THE PURPOSE OF ASSISTING IN LOCATING THE LAND AND THE RECORDER ASSUMES NO LIABILITY FOR VARIATIONS IF ANY WITH AN ACTUAL SURVEY

Section  $\frac{17}{20} \frac{16}{21}$  T 8 N. R 6 E.

book page

drawn by DRW date 6-80

scale 1" = 800'