

RICH COUNTY  
SECTION 29, T 8 N R 5 E, SLB&M

SERIAL NO = -12-29-000 PARCEL

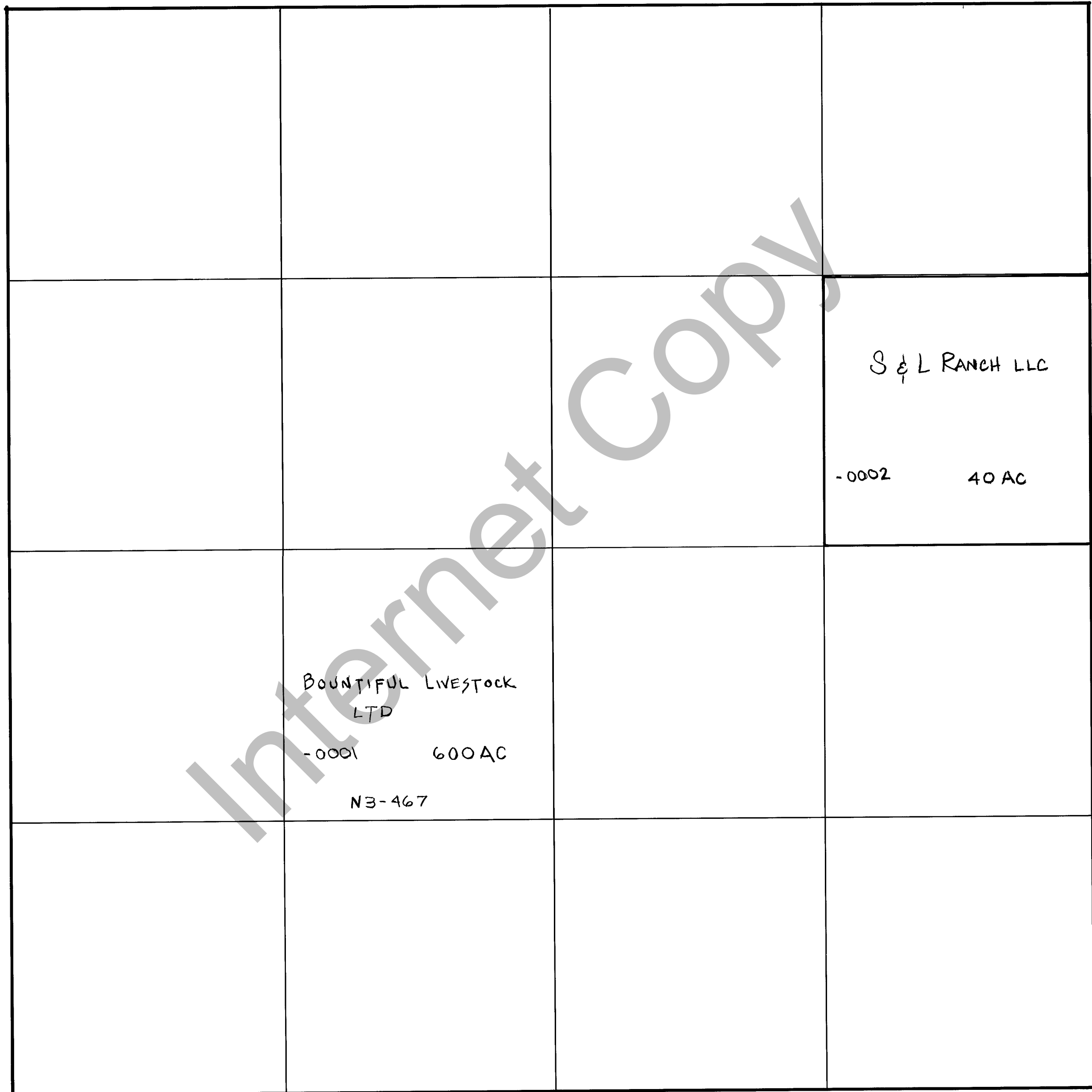

REVISIONS

12-10-79		

THIS PLAT IS MADE SOLELY FOR THE PURPOSE OF ASSISTING IN LOCATING THE LAND AND THE RECORDER ASSUMES NO LIABILITY FOR VARIATIONS, IF ANY WITH AN ACTUAL SURVEY

Section 29 T 8N R 5E

drawn by DE date 9-79

book page

scale 1 1/2" = 400'