

RICH COUNTY
 SECTION 28, T 8 N R 5 E, SLB&M

SERIAL NO = 12 28-000² PARCEL

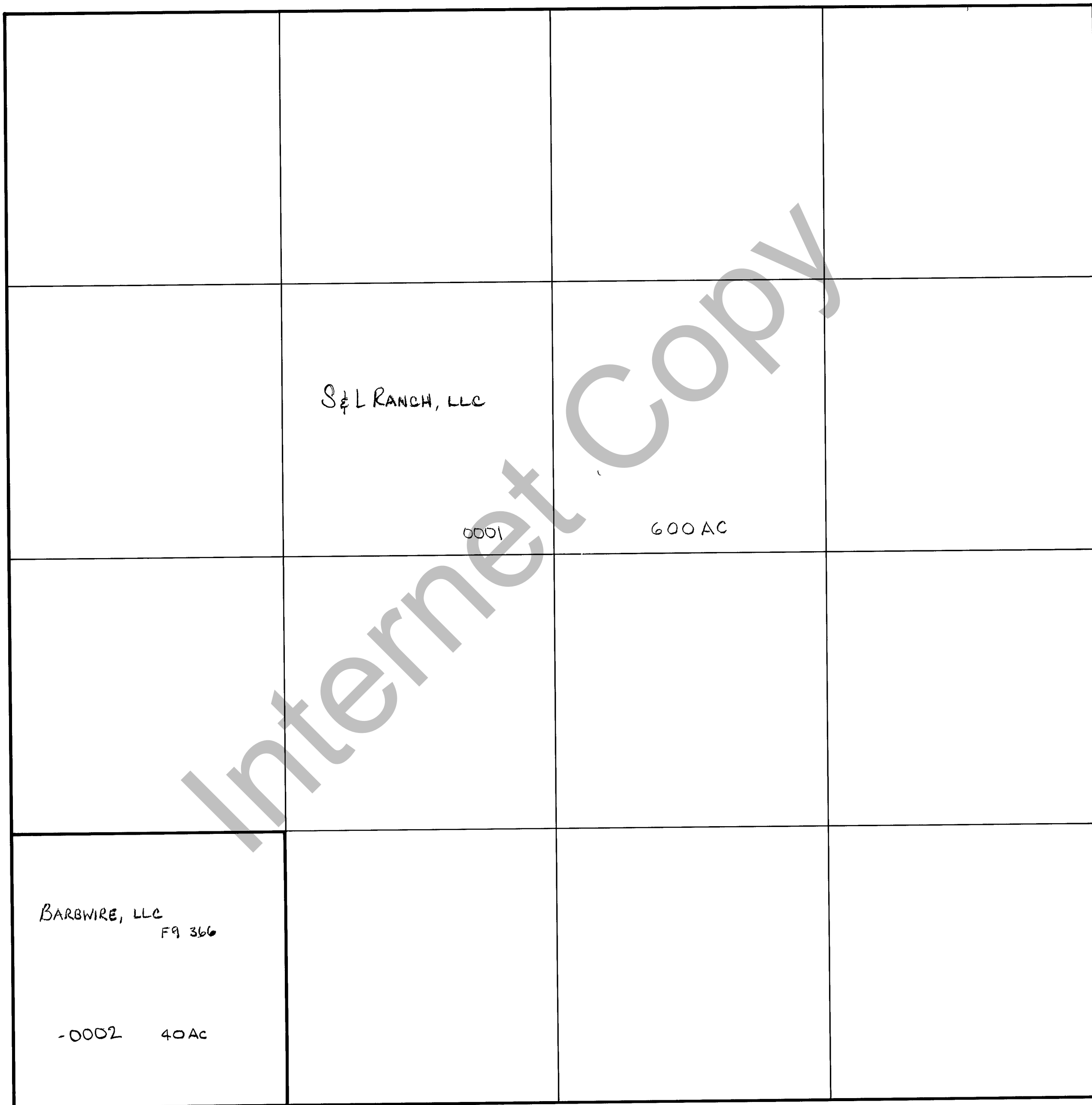

REVISIONS	
08-79	

THIS PLAT IS MADE SOLELY FOR THE PURPOSE OF ASSISTING IN LOCATING THE LAND AND THE RECORDER AS SUMES NO LIABILITY FOR VARIATIONS IF ANY WITH AN ACTUAL SURVEY

Section 28 T 8 N R 5 E	book	page
drawn by DE	date 9-79	scale 1"=400'