

RICH COUNTY
SECTION 26, T 8 N R 5 E, S.L.B&M

SERIAL NO = -12-26-000-PARCEL

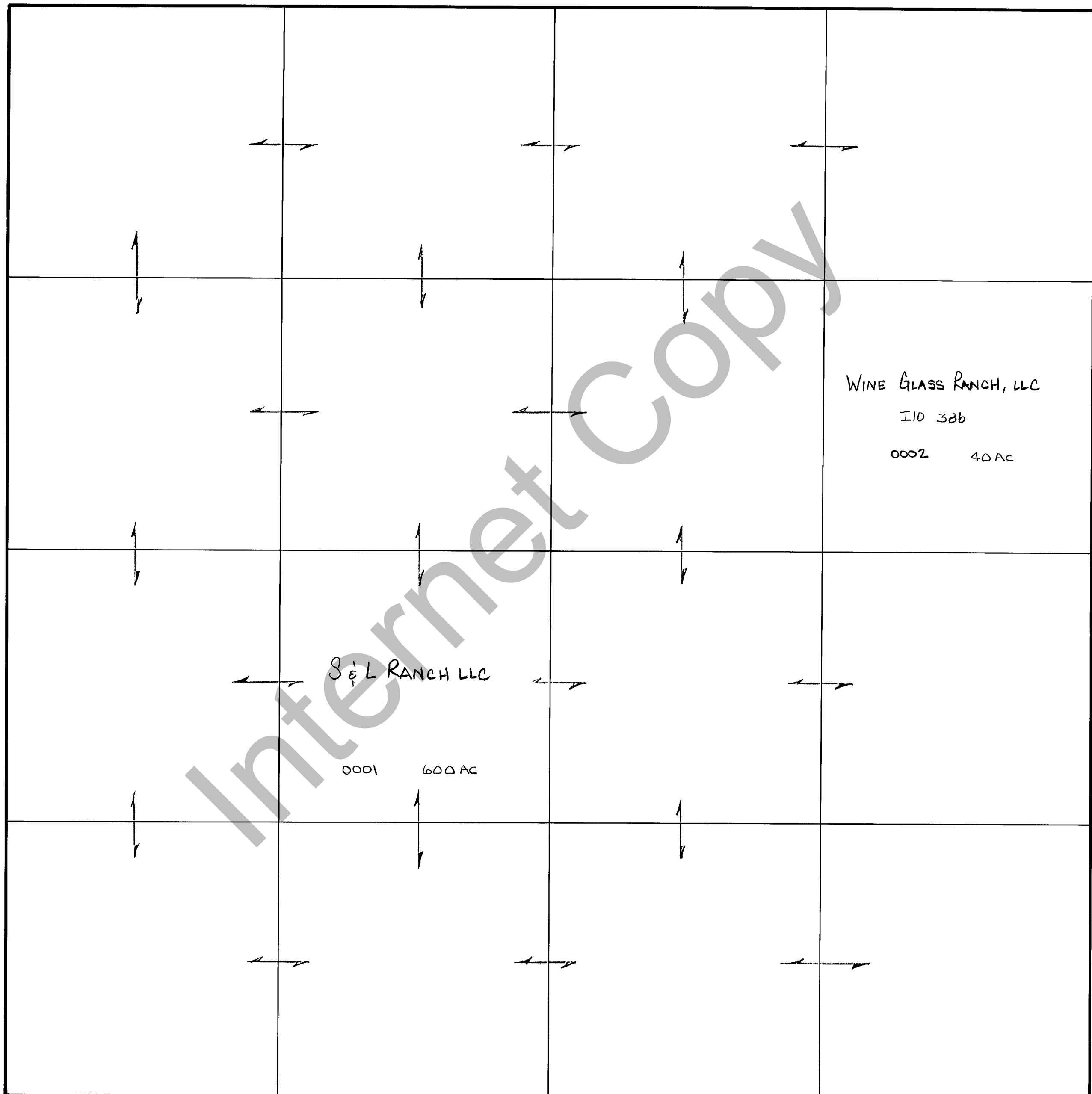

REVISIONS	
1/3/10-79	

THIS PLAT IS MADE SOLELY FOR THE PURPOSE OF ASSISTING IN LOCATING THE LAND AND THE RECORDS AS SUMES NO LIABILITY FOR VARIATIONS IF ANY WITH AN ACTUAL SURVEY

Section 26 T 8 N R 5 E

drawn by DE

date 9-79

book page

scale 1"=400'