

RICH COUNTY
SECTION 20, T 8 N R 5 E, SLB&M

SERIAL NO = 12-20-000 PARCEL

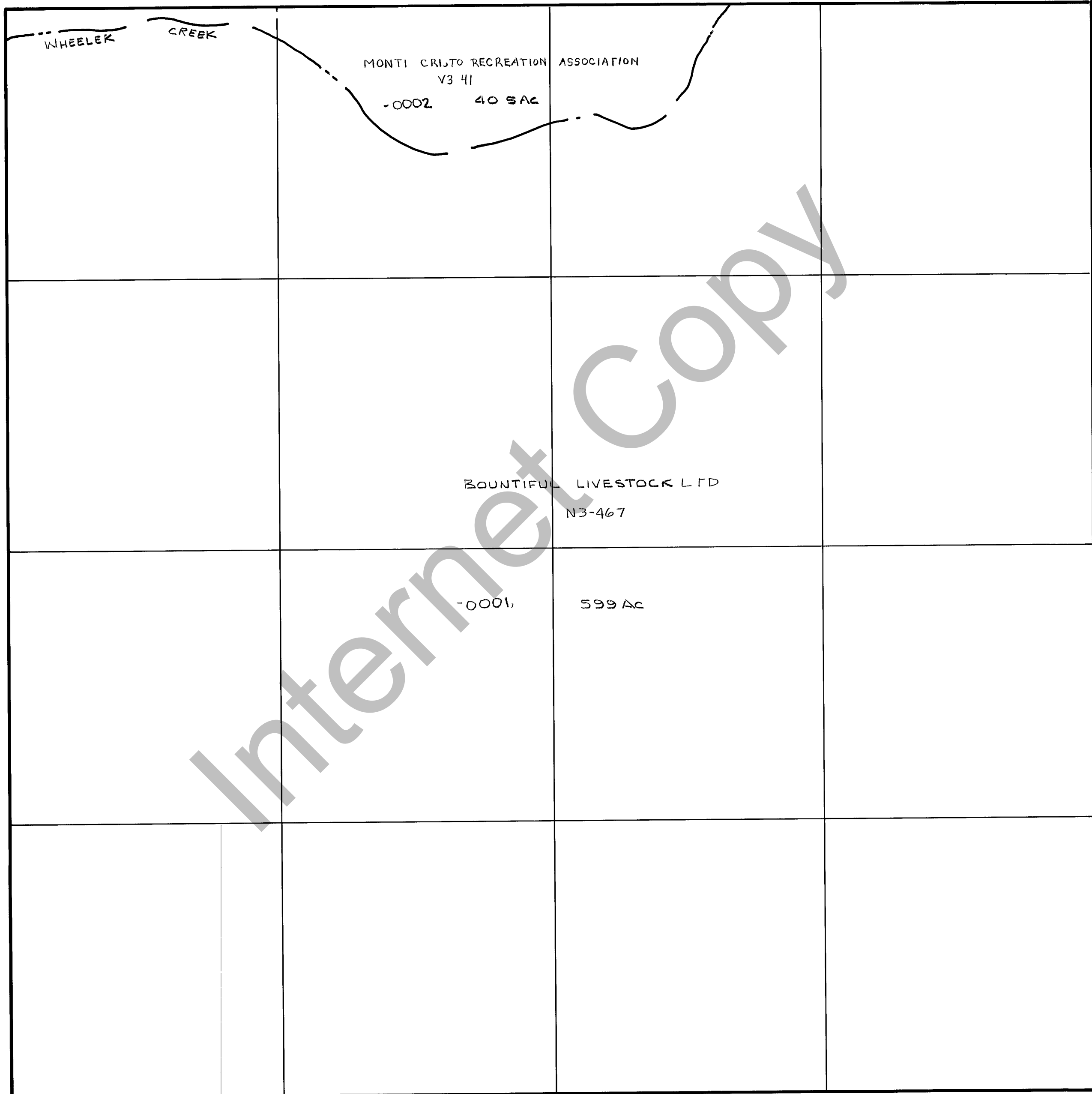

Internet Copy

REVISIONS	
08 10 77	

THIS PLAT IS MADE SOLELY FOR THE PURPOSE OF ASSISTING IN LOCATING THE LAND AND THE RECORDER ASSUMES NO LIABILITY FOR VARIATIONS IF ANY WITH AN ACTUAL SURVEY

Section 20 T 8 N R 5 E	book	page
drawn by DE	date 9-79	scale 1/2" = 400'