

RICH COUNTY  
SECTION 13, T 8 N R 5 E, SLB&M

SERIAL NO = -12-13-000 PARCEL

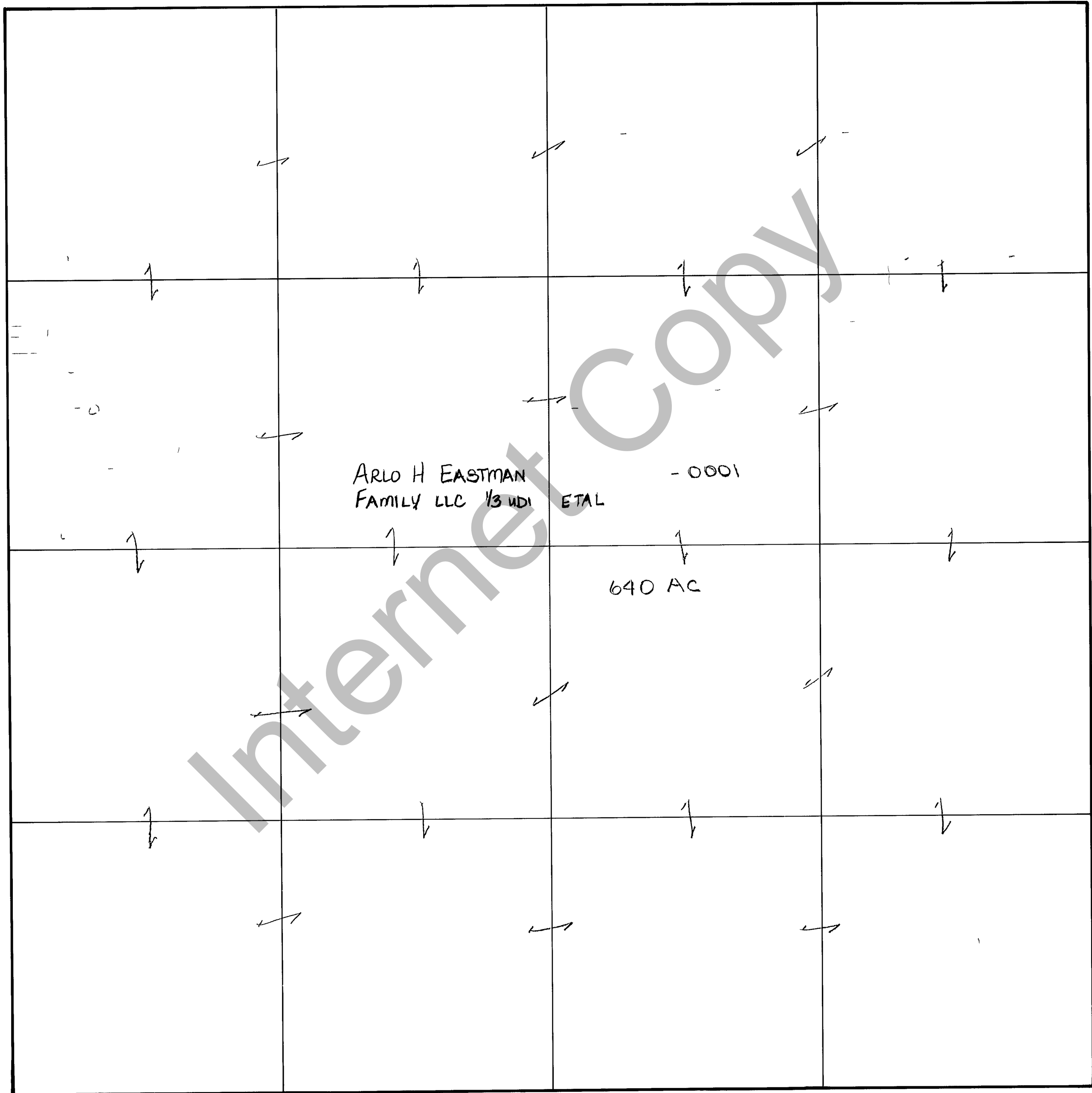

REVISIONS	
06-10-79	

THIS PLAT IS MADE SOLELY FOR THE PURPOSE OF ASSISTING IN LOCATING THE LAND AND THE RECORDER ASSUMES NO LIABILITY FOR VARIATIONS IF ANY WITH AN ACTUAL SURVEY

Section 13 T 8 N R 5 E

book \_\_\_\_\_ page \_\_\_\_\_

drawn by DE date 9-79

scale 1"=400'