

RICH COUNTY
 T. 7 N. R. 5 E, S. L. B. & M

PARCEL NO = 07-SEC-000-PARCEL

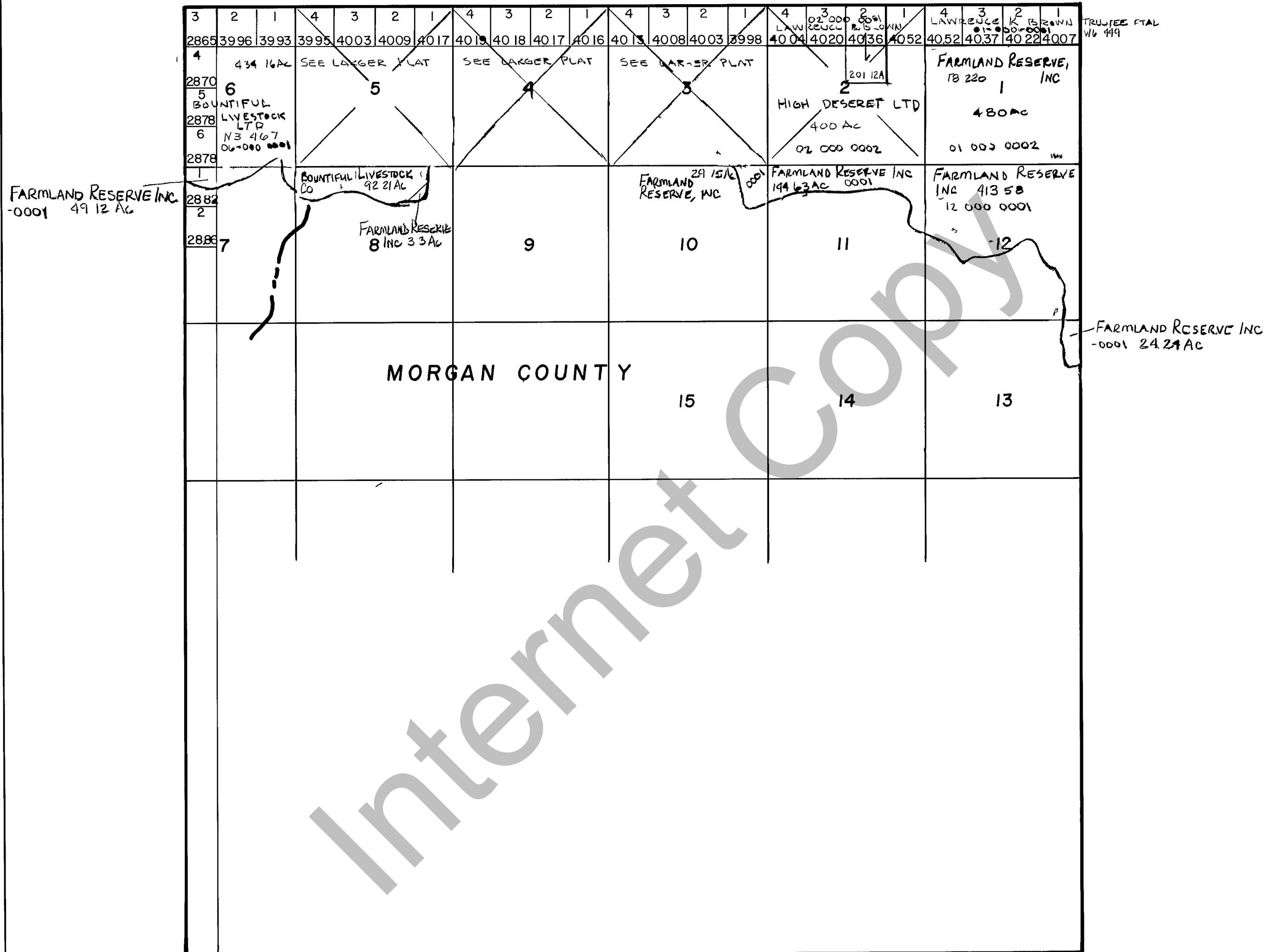

REVISIONS		THIS PLAT IS MADE SOLELY FOR THE PURPOSE OF ASSISTING IN LOCATING THE LAND AND THE RECORDER ASSUMES NO LIABILITY FOR VARIATIONS IF ANY WITH AN ACTUAL SURVEY	Section T. 7 N. R. 5 E		book	page
1	8/10/79					
2						
3						
4						
5						
6						
7						
8						
9						
10						
11						
12						
13						
14						
15						
			drawn by DE	date 8-79	scale 1"=3000'	