

RICH COUNTY  
SECTION 17 T 5 N. R 7 E, S. LB & M

SERIAL NO 02-17-000-PARCEL

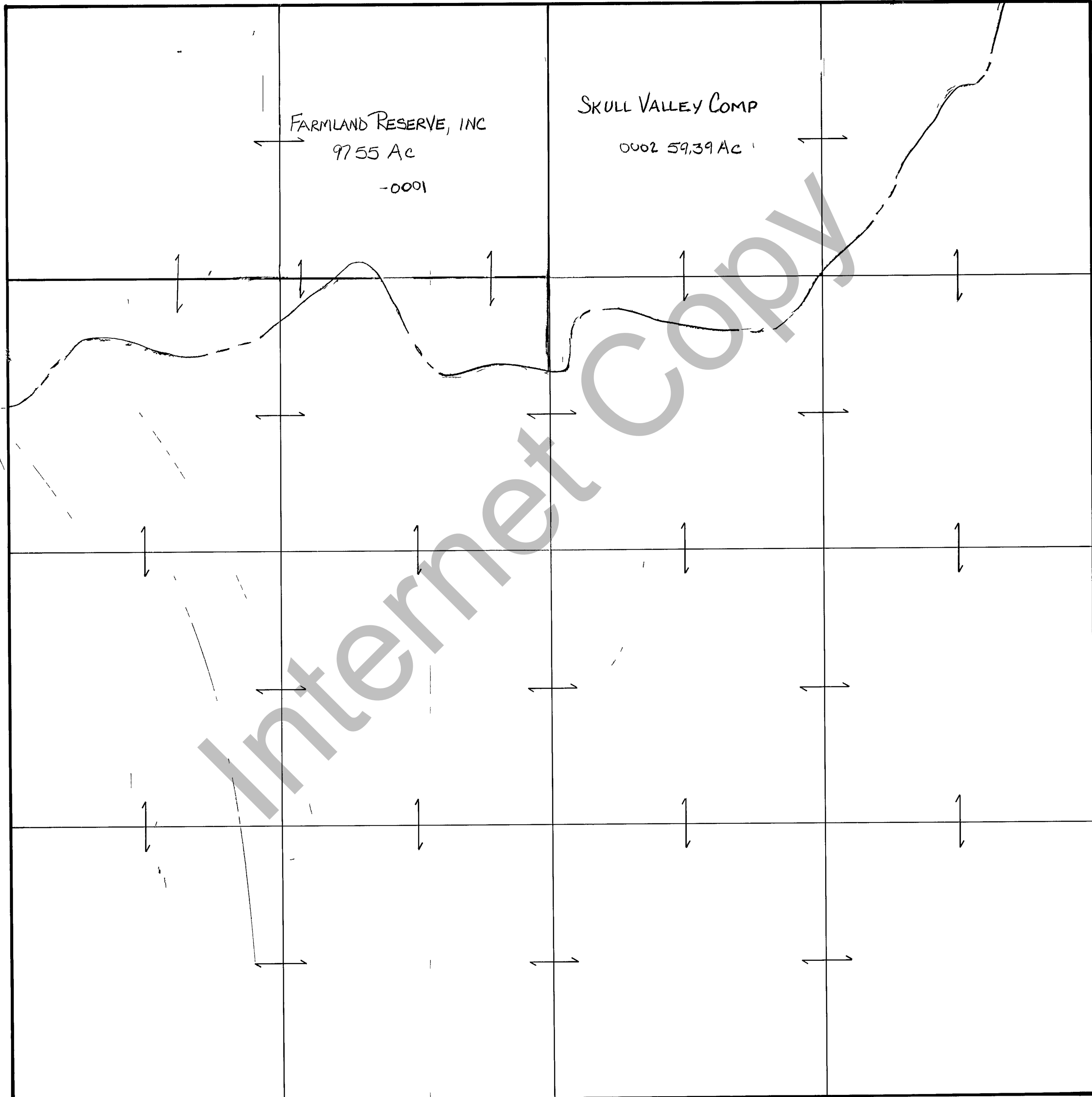

Internet Copy

REVISIONS		

THIS PLAT IS MADE SOLELY FOR THE PURPOSE OF ASSISTING IN LOCATING THE LAND AND FILE RECORDER AS SUMED TO THE WITH VARIATIONS IF ANY WITH AN ACTUAL SURVEY

Section <u>17 T 5 N R 7 E</u>	book _____	page _____
drawn by <u>DRW</u> date <u>6-80</u>	scale <u>1"=400'</u>	